



POWER TOOLS

www.pro-powertools.com



CHOICE OF A CHAMPION

Part of the Atlas Copco Group





Designed for a carefree life

No detail is too small for PRO industrial tools. Durable Swedish design, top-notch performance and unmatched technical support make owning a PRO tool easy. We sweat the small stuff, so you don't have to.

PRO tools deliver unequalled quality, performance and durability. As a brand for industrial users, PRO is widely recognised around the world as the natural choice for professional-grade tools.

IMPACT WRENCHES	5
RATCHET WRENCHES	12
BATTERY TOOLS	15
SCREWDRIVERS	19
DRILLS	25
GRINDERS	29
SANDERS	36
PERCUSSIVE TOOLS	43
HOSE REELS	50
VIBRATION / NOISE VALUES	52
SPARE PARTS	55
DIMENSIONAL DRAWINGS	57

How to use our tools safely

Some safety tips

Below are few tips to increase power tool safety and help avoid injury and accidents. These tips, however, are no substitute for the PRO tools safety and instruction manuals.



Conduct a visual inspection of the tool before use

Check the tool, including hoses or fittings, for signs of damage and replace defect parts if necessary. Check for cracks in the sockets, grinding wheels, chisels, etc., and replace damaged parts if required.



Check the free speed of the tool

Make sure the measured speed at a pressure of 6.3 bar does not exceed the rated speed of the tool. Before checking the measured speed, always remove wheels, burrs, sockets, etc.



Use the right accessories

Always use the accessories recommended in the safety manual. Never use hand sockets with impact or ratchet wrenches. Never use a grinding wheel, burr, cone wheel, etc., marked with a speed lower than the speed of the grinder. Always disconnect the air tool before changing accessories.



Wear safety gear

Always use appropriate safety equipment, such as goggles and earplugs. When required, wear gloves, apron and helmet. When working with materials that produce airborne particles, be sure to wear a dust mask or similar protective gear and use other equipment, such as dust extractors, to control exposure to harmful substances.



Before grinding, test the tool

Test run the grinder in a protected area before starting work and after changing the wheel. Make sure that the space around is free from other people.

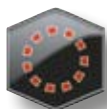

Maintain a safe work area

Keep other people at a safe distance away from your workspace while you use the tools. Beware of hoses on the walking or work surface. Always direct exhaust air away from yourself and others. Never use an air tool in explosive atmospheres. Stay away from electric wiring because an air tool is not insulated for contact with electrical power sources.



After work

Always disconnect your air tool after use.

Safe hand tool operation is a fundamental tenet of PRO tool design. All of our tools have features that safeguard operators against work-related injuries and machine-related hazards. But the best way to ensure hand tool safety is to ensure that operators use the recommended safety practices. That is why each PRO tool comes with a safety and instruction manual

that operators should read and follow when using our tools. For a copy of these manuals, contact your local PRO representative.

For more information on safe power tool operation, please refer to the rules for tool safety from these two organizations:
Safety Code for Portable Air Tools, ANSI B186.1
American National Standards Institute (ANSI)

11 W. 42nd St, 13th floor, New York, NY 10036.
Further occupational health and safety information can be obtained from the following web sites:
<http://www.osha.gov> (USA)
<http://europe.osha.eu.int> (Europe)



Impact Wrenches

The PRO wrenches consist of a wide range of tools to suit your needs. PRO Compact are light weighted tools with composite housing and twin hammer mechanism for the best

power-to-weight ratio. All impact wrenches are built for speed and comfort. Regardless of your choice within the PRO range the tool will do the job for you.

Impact & Ratchet wrench selection guide

Need the power to tighten or loosen a nut with a specified amount of torque?

PRO has just the right impact wrenches for you. PRO Impact Wrenches are perfect for automotive repair, heavy equipment maintenance, product assembly, major construction

projects or any other application that requires high torque output.

Simply choose the PRO impact wrenches that handle the torque range you require. As a general rule, we recommend selecting the impact wrench that has your ideal torque

value within the middle of the tool's torque range.

Naturally, the actual final applied torque value may differ slightly from the design torque value, depending on factors such as fastener type and size, joint rate and air pressure.

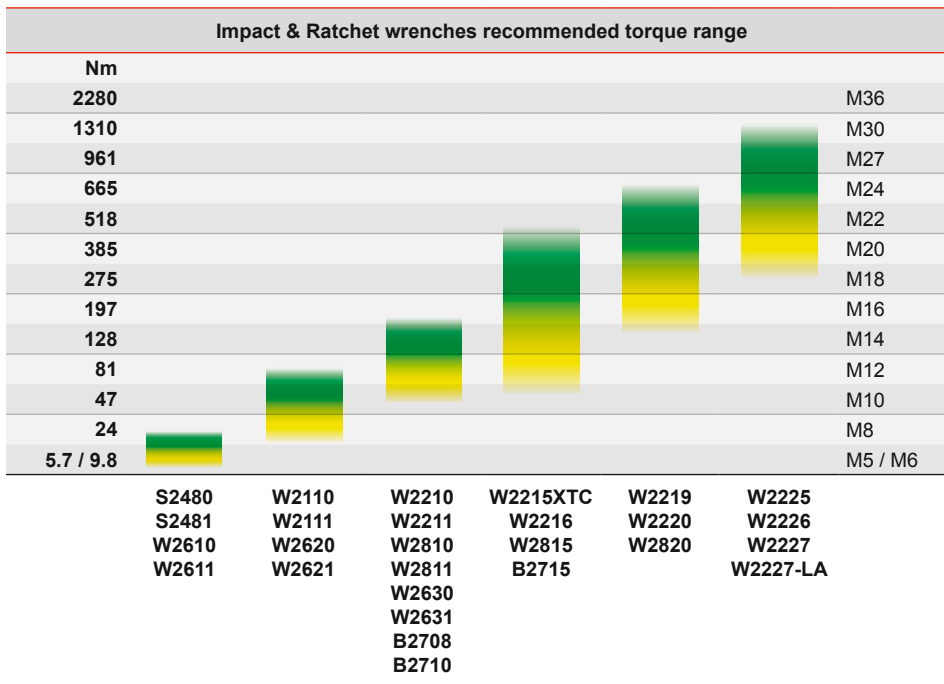

How the max torque is measured

The common way of measuring the max torque on impact wrenches is by running the tool on a torque

tester called Skidmore-Wilhelm®. Depending of the size of the impact wrench different torque testers are

used according to the table below.

Anvil	Hose Ø	Hose length	Skidmore type	Bolt
1/4 inch	10 mm	2.5 m	model J	5/8"
3/8 inch	10 mm	2.5 m	model J	7/8"
1/2 inch	10 mm	2.5 m	model M/RL	1"
3/4 inch	13 mm	3 m	model H	1 1/4"
1 inch	16 mm	3 m	model K	1 3/4"

When comparing and evaluating stated torque levels in this catalogue equipment as above described must be used.



PRO COMPACT LINE IMPACT WRENCHES

High-powered. Ultralight. A smooth operator.

Perfect for tackling the toughest industrial jobs, PRO Compact Impact Wrenches deliver the best power-to-weight ratio within the PRO range.

Powered by an advanced twin hammer mechanism, these compact impacts deliver virtuoso performance and state-of-the-art vibration damping and noise reduction technology.

New! Available - July 1 - 2010

PRO COMPACT W2810

Square drive	3/8" (10 mm)
Clutch type	Twin hammer
Capacity	M14
Torque range	200-360 Nm
Max torque fwd	470 Nm
Speed	10 000 rpm
Weight	1.3 kg
Length	160 mm
Vibration level	p. 52-54
Sound level	p. 52-54
Air consumption	10 l/s
Suitable air hose	10 mm (3/8")
Air inlet thread	1/4" BSP
Ordering No.	8434 1248 10



New! Available - July 1 - 2010

PRO COMPACT W2811

Square drive	1/2" (12.7 mm)
Clutch type	Twin hammer
Capacity	M14
Torque range	200-360 Nm
Max torque fwd	470 Nm
Speed	10 000 rpm
Weight	1.3 kg
Length	160 mm
Vibration level	p. 52-54
Sound level	p. 52-54
Air consumption	10 l/s
Suitable air hose	10 mm (3/8")
Air inlet thread	1/4" BSP
Ordering No.	8434 1248 11



New! Available - June 1 - 2010

PRO COMPACT W2815

Square drive	1/2" (12.7 mm)
Clutch type	Twin hammer
Capacity	M16
Torque range	300-680 Nm
Max torque fwd	1 085 Nm
Speed	7 400 rpm
Weight	2.0 kg
Length	191 mm
Vibration level	p. 52-54
Sound level	p. 52-54
Air consumption	16 l/s
Suitable air hose	10 mm (3/8")
Air inlet thread	1/4" BSP
Ordering No.	8434 1248 15



New! Available - August 1 - 2010

PRO COMPACT W2820

Square drive	3/4" (19 mm)
Clutch type	Twin hammer
Capacity	M22
Torque range	350-920 Nm
Max torque fwd	1 490 Nm
Speed	4 500 rpm
Weight	3.8 kg
Length	240 mm
Vibration level	p. 52-54
Sound level	p. 52-54
Air consumption	20 l/s
Suitable air hose	13 mm (1/2")
Air inlet thread	3/8" BSP
Ordering No.	8434 1248 20



PRO COMPACT W2816.

W2815 with pin-retainer

Ordering No. 8434 1248 16





PRO COMPACT LINE IMPACT WRENCHES

PRO COMPACT W2309

Square drive	7/16" Hex QC
Clutch type	Twin hammer
Capacity	M14
Torque range	220-360 Nm
Max torque fwd	400 Nm
Free speed	10 000 r/min
Weight	1.3 kg
Length	175 mm
Vibration level	p. 52-54
Sound level	p. 52-54
Air consumption	8.3 l/s
Suitable air hose	10 mm (3/8")
Air inlet thread	1/4" BSP
Ordering No.	8434 1245 09



PRO COMPACT W2310

Square drive	3/8" (10 mm)
Clutch type	Twin hammer
Capacity	M14
Torque range	220-360 Nm
Max torque fwd	400 Nm
Free speed	10 000 r/min
Weight	1.25 kg
Length	160 mm
Vibration level	p. 52-54
Sound level	p. 52-54
Air consumption	8.3 l/s
Suitable air hose	10 mm (3/8")
Air inlet thread	1/4" BSP
Ordering No.	8434 1245 10



PRO COMPACT W2311

Square drive	1/2" (12.7 mm)
Clutch type	Twin hammer
Capacity	M14
Torque range	220-360 Nm
Max torque fwd	400 Nm
Free speed	10 000 r/min
Weight	1.25 kg
Length	160 mm
Vibration level	p. 52-54
Sound level	p. 52-54
Air consumption	8.3 l/s
Suitable air hose	10 mm (3/8")
Air inlet thread	1/4" BSP
Ordering No.	8434 1245 11





PRO COMPACT LINE IMPACT WRENCHES



PRO COMPACT W2315

Square drive	1/2" (12.7 mm)
Clutch type	Twin hammer
Capacity	M22
Torque range	320-610 Nm
Max torque fwd	780 Nm
Free speed	7 000 r/min
Weight	2.0 kg
Length	190 mm
Vibration level	p. 52-54
Sound level	p. 52-54
Air consumption	12 l/s
Suitable air hose	10 mm (3/8")
Air inlet thread	1/4" BSP
Ordering No.	8434 1245 15



PRO COMPACT W2320

Square drive	3/4" (19 mm)
Clutch type	Twin hammer
Capacity	M27
Torque range	340-870 Nm
Max torque fwd	1 050 Nm
Free speed	4 000 r/min
Weight	3.8 kg
Length	240 mm
Vibration level	p. 52-54
Sound level	p. 52-54
Air consumption	19 l/s
Suitable air hose	13 mm (1/2")
Air inlet thread	3/8" BSP
Ordering No.	8434 1245 20

PRO EXPLOSION PROOF IMPACT WRENCHES

ATEX-certified for hazardous environments

PRO Compact XP tools meet stringent European standards and comply with ATEX Directive I M2 II 2G IIB T4 II2D 135°. These explosion-proof products are designed for use in hazardous environments, such as coal mines, petrochemical plants or wherever a spark-reduced safety tool is required.



PRO COMPACT W2315XP

Square drive	1/2" (12.7 mm)
Clutch type	Twin hammer
Capacity	M22
Torque range	320-610 Nm
Max torque fwd	780 Nm
Speed	7 000 r/min
Weight	2.52 kg
Length	190 mm
Vibration level	p. 52-54
Sound level	p. 52-54
Air consumption	12 l/s
Suitable air hose	10 mm (3/8")
Air inlet thread	1/4" BSP
Ordering No.	8434 1245 17



PRO COMPACT W2320XP

Square drive	3/4" (19 mm)
Clutch type	Twin hammer
Capacity	M24
Torque range	340-870 Nm
Max torque fwd	1 050 Nm
Speed	4 000 r/min
Weight	4.72 kg
Length	240 mm
Vibration level	p. 52-54
Sound level	p. 52-54
Air consumption	19 l/s
Suitable air hose	13 mm (1/2")
Air inlet thread	3/8" BSP
Ordering No.	8434 1245 22



IMPACT WRENCHES

PRO W2110 HEX

Quick change	HEX
Clutch type	Double hammer
Capacity	M12
Torque range	13-70 Nm
Max torque fwd	94 Nm
Speed	8 000 r/min
Weight	0.98 kg
Length	160 mm
Vibration level	p. 52-54
Sound level	p. 52-54
Air consumption	8.7 l/s
Suitable air hose	10 mm (3/8")
Air inlet thread	1/4" BSP
Ordering No.	8434 1244 20



PRO W2111 3/8"

Square drive	3/8" (10 mm)
Clutch type	Double hammer
Capacity	M12
Torque range	13-70 Nm
Max torque fwd	94 Nm
Speed	8 000 r/min
Weight	0.98 kg
Length	154 mm
Vibration level	p. 52-54
Sound level	p. 52-54
Air consumption	8.7 l/s
Suitable air hose	10 mm (3/8")
Air inlet thread	1/4" BSP
Ordering No.	8434 1244 23



PRO W2210A 3/8"

Square drive	3/8" (10 mm)
Clutch type	Single hammer
Capacity	M14
Torque range	70-180 Nm
Max torque fwd	270 Nm
Speed	9 000 r/min
Weight	1.7 kg
Length	160 mm
Vibration level	p. 52-54
Sound level	p. 52-54
Air consumption	8.7 l/s
Suitable air hose	10 mm (3/8")
Air inlet thread	1/4" BSP
Ordering No.	8434 1244 31



PRO W2211 1/2"

Square drive	1/2" (12.7 mm)
Clutch type	Single hammer
Capacity	M14
Torque range	70-180 Nm
Max torque fwd	270 Nm
Speed	9 000 r/min
Weight	1.7 kg
Length	160 mm
Vibration level	p. 52-54
Sound level	p. 52-54
Air consumption	8.7 l/s
Suitable air hose	10 mm (3/8")
Air inlet thread	1/4" BSP
Ordering No.	8434 1244 33



PRO W2216 1/2"

Square drive	1/2" (12.7 mm)
Clutch type	Single hammer
Capacity	M20
Torque range	150-640 Nm
Max torque fwd	720 Nm
Speed	7 000 r/min
Weight	2.5 kg
Length	195 mm
Vibration level	p. 52-54
Sound level	p. 52-54
Air consumption	11.6 l/s
Suitable air hose	10 mm (3/8")
Air inlet thread	1/4" BSP
Ordering No.	8434 1244 75



PRO W2215XTC 1/2" Composite

Square drive	1/2" (12.7 mm)
Clutch type	Twin hammer
Capacity	M22
Torque range	350-650 Nm
Max torque fwd	820 Nm
Speed	7 500 r/min
Weight	2.1 kg
Length	190 mm
Vibration level	p. 52-54
Sound level	p. 52-54
Air consumption	11.4 l/s
Suitable air hose	10 mm (3/8")
Air inlet thread	1/4" BSP
Ordering No.	8434 1244 80



IMPACT WRENCHES

PRO W2219 3/4"

Square drive	3/4" (19 mm)
Clutch type	Single hammer
Capacity	M22
Torque range	450-700 Nm
Max torque fwd	1 030 Nm
Speed	3 800 r/min
Weight	5.1 kg
Length	255 mm
Vibration level	p. 52-54
Sound level	p. 52-54
Air consumption	12.2 l/s
Suitable air hose	10 mm (3/8")
Air inlet thread	1/4" BSP

Ordering No. 8434 1244 37



PRO W2220 3/4"

Square drive	3/4" (19 mm)
Clutch type	Twin hammer
Capacity	M30
Torque range	670-1 200 Nm
Max torque fwd	1 300 Nm
Speed	3 800 r/min
Weight	6.3 kg
Length	270 mm
Vibration level	p. 52-54
Sound level	p. 52-54
Air consumption	18 l/s
Suitable air hose	13 mm (1/2")
Air inlet thread	3/8" BSP

Ordering No. 8434 1244 39



PRO W2225C 1"

Square drive	1" (25.4 mm)
Clutch type	Single hammer
Capacity	M30
Torque range	400-1 040 Nm
Max torque fwd	1 660 Nm
Speed	3 800 r/min
Weight	10.1 kg
Length	290 mm
Vibration level	p. 52-54
Sound level	p. 52-54
Air consumption	19.9 l/s
Suitable air hose	13 mm (1/2")
Air inlet thread	3/8" BSP

Ordering No. 8434 1244 54



PRO W2226C 1"

Square drive	1" (25.4 mm)
Clutch type	Twin hammer
Capacity	M30
Torque range	670-1 200 Nm
Max torque fwd	1 300 Nm
Speed	3 800 r/min
Weight	6.8 kg
Length	270 mm
Vibration level	p. 52-54
Sound level	p. 52-54
Air consumption	18 l/s
Suitable air hose	13 mm (1/2")
Air inlet thread	3/8" BSP

Ordering No. 8434 1244 56



PRO W2227 1"

Square drive	1" (25.4 mm)
Clutch type	Twin hammer
Capacity	M30
Torque range	670-1 200 Nm
Max torque fwd	1 300 Nm
Speed	5 000 r/min
Weight	6.8 kg
Length	355 mm
Vibration level	p. 52-54
Sound level	p. 52-54
Air consumption	18 l/s
Suitable air hose	13 mm (1/2")
Air inlet thread	3/8" BSP

Ordering No. 8434 1244 58



PRO W2227-LA

Square drive	1" (25.4 mm)
Clutch type	Twin hammer
Capacity	M30
Torque range	670-1 200 Nm
Max torque fwd	1 300 Nm
Speed	5 000 r/min
Weight	7.1 kg
Length	507 mm
Vibration level	p. 52-54
Sound level	p. 52-54
Air consumption	18 l/s
Suitable air hose	13 mm (1/2")
Air inlet thread	3/8" BSP

Ordering No. 8434 1244 59





Ratchet Wrenches

All powerful and reversible, PRO ratchet wrenches are designed for easy access in confined spaces. Get more torque from the PRO Compact

line with its unique composite housing that provides improved ergonomics, thanks to reduced vibrations and greater power-to-weight ratio.



PRO COMPACT LINE RATCHET WRENCHES

New! Available - June 1 - 2010

PRO COMPACT W2630

Square drive	1/2" (12.7 mm)
Capacity	M14
Torque range	25-80 Nm
Speed	200 rpm
Weight	1.2 kg
Length	307 mm
Vibration level	p. 52-54
Sound level	p. 52-54
Air consumption	11 l/s
Suitable air hose	10 mm (3/8")
Air inlet thread	1/4" BSP
Ordering No.	8431 0350 30



New! Available - June 1 - 2010

PRO COMPACT W2631

Square drive	3/8" (10 mm)
Capacity	M14
Torque range	25-80 Nm
Speed	200 rpm
Weight	1.2 kg
Length	307 mm
Vibration level	p. 52-54
Sound level	p. 52-54
Air consumption	11 l/s
Suitable air hose	10 mm (3/8")
Air inlet thread	1/4" BSP
Ordering No.	8431 0350 31



New! Available - June 1 - 2010

PRO COMPACT W2620

Square drive	1/2" (12.7 mm)
Capacity	M12
Torque range	5-68 Nm
Speed	170 rpm
Weight	1.1 kg
Length	271 mm
Vibration level	p. 52-54
Sound level	p. 52-54
Air consumption	10 l/s
Suitable air hose	10 mm (3/8")
Air inlet thread	1/4" BSP
Ordering No.	8431 0350 20



New! Available - June 1 - 2010

PRO COMPACT W2621

Square drive	3/8" (10 mm)
Capacity	M12
Torque range	5-68 Nm
Speed	170 rpm
Weight	1.1 kg
Length	271 mm
Vibration level	p. 52-54
Sound level	p. 52-54
Air consumption	10 l/s
Suitable air hose	10 mm (3/8")
Air inlet thread	1/4" BSP
Ordering No.	8431 0350 21



New! Available - June 1 - 2010

PRO COMPACT W2610

Square drive	3/8" (10 mm)
Capacity	M8
Torque range	4-40 Nm
Speed	280 rpm
Weight	0.55 kg
Length	192 mm
Vibration level	p. 52-54
Sound level	p. 52-54
Air consumption	9 l/s
Suitable air hose	10 mm (3/8")
Air inlet thread	1/4" BSP
Ordering No.	8431 0350 10



New! Available - June 1 - 2010

PRO COMPACT W2611

Square drive	1/4" (6.3 mm)
Capacity	M8
Torque range	4-40 Nm
Speed	280 rpm
Weight	0.55 kg
Length	192 mm
Vibration level	p. 52-54
Sound level	p. 52-54
Air consumption	9 l/s
Suitable air hose	10 mm (3/8")
Air inlet thread	1/4" BSP
Ordering No.	8431 0350 11





PRO COMPACT LINE RATCHET WRENCHES

- Swivelling air inlet and exhaust
- Adjustable torque
- Good ergonomics

PRO COMPACT W2300 3/8"

Square drive	3/8" (10 mm)
Capacity	M12
Torque range	5-68 Nm
Speed	150 r/min
Weight	1.2 kg
Length	258 mm
Vibration level	p. 52-54
Sound level	p. 52-54
Air consumption	7.2 l/s
Suitable air hose	10 mm (3/8")
Air inlet thread	1/4" BSP
Ordering No.	8431 0350 00



PRO COMPACT W2301 1/2"

Square drive	1/2" (12.7 mm)
Capacity	M12
Torque range	5-68 Nm
Speed	150 r/min
Weight	1.2 kg
Length	258 mm
Vibration level	p. 52-54
Sound level	p. 52-54
Air consumption	7.2 l/s
Suitable air hose	10 mm (3/8")
Air inlet thread	1/4" BSP
Ordering No.	8431 0350 01



PRO COMPACT W2302 1/4"

Square drive	1/4" (6.3 mm)
Capacity	M8
Torque range	3-30 Nm
Speed	200 r/min
Weight	0.5 kg
Length	195 mm
Vibration level	p. 52-54
Sound level	p. 52-54
Air consumption	3.4 l/s
Suitable air hose	10 mm (3/8")
Air inlet thread	1/4" BSP
Ordering No.	8431 0350 04



PRO COMPACT W2303 3/8"

Square drive	3/8" (10 mm)
Capacity	M8
Torque range	3-30 Nm
Speed	200 r/min
Weight	0.5 kg
Length	195 mm
Vibration level	p. 52-54
Sound level	p. 52-54
Air consumption	3.4 l/s
Suitable air hose	10 mm (3/8")
Air inlet thread	1/4" BSP
Ordering No.	8431 0350 03



PRO COMPACT W2200 3/8"

Square drive	3/8" (10 mm)
Capacity	M10
Torque range	5-40 Nm
Speed	150 r/min
Weight	1.1 kg
Length	264 mm
Vibration level	p. 52-54
Sound level	p. 52-54
Air consumption	7.6 l/s
Suitable air hose	10 mm (3/8")
Air inlet thread	1/4" BSP
Ordering No.	8431 0349 10



PRO COMPACT W2201 1/2"

Square drive	1/2" (12.7 mm)
Capacity	M10
Torque range	5-40 Nm
Speed	150 r/min
Weight	1.1 kg
Length	264 mm
Vibration level	p. 52-54
Sound level	p. 52-54
Air consumption	7.6 l/s
Suitable air hose	10 mm (3/8")
Air inlet thread	1/4" BSP
Ordering No.	8431 0349 02





Battery tools

The PRO battery tools have the latest Li-Ion battery technology for long working cycles throughout the charge and for excellent power to weight ratio of the tools. All the tools have

an impact mechanism for fast run down and maximum torque. The tools are durable and the battery packs are rubber coated to protect the battery and not damage the work surface.



BATTERY TOOLS

• Excellent power to weight ratio • Li-Ion technology

The PRO battery tools are well balanced and ready for the toughest industrial jobs with features like rubber coated handle, universal charger that works with both 10.8V and 18V batteries, easy quick battery connection. B2708 and B2710 have a LED guide light that will illuminate at the beginning of trigger pull before the tool starts to run. The tools are delivered in complete kits including, tool, 2 batteries, charger, cable and carrying case.

PRO B2708

Drive	1/4" quick change
Clutch type	Duo pac
Capacity	M14
Max torque	130 Nm
Torque range	15-95 Nm
Speed	2 400 r/min
Weight	1.65 kg
Vibration level	p. 52-54
Sound level	p. 52-54
Voltage	10.8 Li-Ion
Amp hours	2.4
Length	171 mm
Light	Yes
No. of batteries incl.	2
Charge time	1 hour
Ordering No.	8434 1246 20

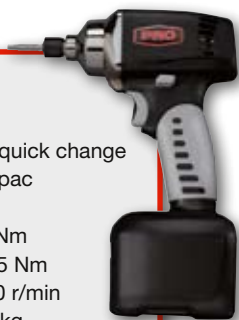

PRO B2710

Drive	3/8"
Clutch type	Duo pac
Capacity	M14
Max torque	130 Nm
Torque range	15-95 Nm
Speed	2 400 r/min
Weight	1.65 kg
Vibration level	p. 52-54
Sound level	p. 52-54
Voltage	10.8 Li-Ion
Amp hours	2.4
Length	171 mm
Light	Yes
No. of batteries incl.	2
Charge time	1 hour
Ordering No.	8434 1246 10

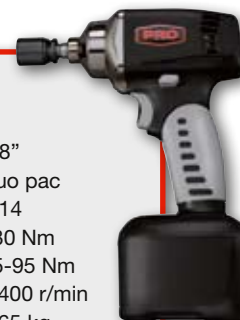

PRO B2715

Drive	1/2"
Clutch type	Duo pac
Capacity	M20
Max torque	575 Nm
Torque range	70-510 Nm
Speed	1 900 r/min
Weight	2.95 kg
Vibration level	p. 52-54
Sound level	p. 52-54
Voltage	18 Li-Ion
Amp hours	2.4
Length	235 mm
Light	No
No. of batteries incl.	2
Charge time	1 hour
Ordering No.	8434 1246 00



PRO B1100 WORK LIGHT

Battery not included	
Works with both 10.8V and 18V batteries.	
Bulb type	LED 16 pcs
Brightness 10 cm	10 000 LUX
Weight	0.29 kg
Length	290 mm
Ordering No.	8434 1246 30



Accessories battery tools

Battery	
10.8V Li-Ion	4112 1545 00
18V Li-Ion	4112 1545 01
Charger	
	4112 1545 02



ACCESSORIES - IMPACT AND RATCHET WRENCHES

New!

PRO WS1001

Square drive	3/8"
Socket type	Metric impact socket
Number of sockets	13
Sockets included	7,8,9,10,11,12,13,14,15,16,17,18,19 mm
Ordering No.	4112 0607 91



New!

PRO WS1002

Square drive	1/2"
Socket type	Metric impact socket
Number of sockets	14
Sockets included	10,11,12,13,14,15,16,17,18,19,21,22,26,27 mm
Ordering No.	4112 0607 92



New!

PRO WS1003

Square drive	1/2"
Socket type	Metric deep impact socket
Number of sockets	14
Sockets included	10,11,12,13,14,15,16,17,18,19,21,22,26,27 mm
Ordering No.	4112 0607 93



Protective covers

Model	Ordering No.
W2215XTC	4112 1347 00
W2219	4112 0396 00
W2315	4112 0396 15





ACCESSORIES - IMPACT AND RATCHET WRENCHES

POWER SOCKETS FOR IMPACT WRENCHES AND RATCHET WRENCHES

Socket size mm	Square drive 3/8" Ordering No.	Square drive 1/2" Ordering No.	Square drive 3/4" Ordering No.	Pin and O-ring ref letter	Square drive 1" Ordering No.	Pin and O-ring ref letter
8	4026 0908 00					
9	4026 0909 00					
10	4026 0910 00	4026 1210 00				
11	4026 0911 00	4026 1211 00				
12	4026 0912 00	4026 1212 00				
13	4026 0913 00	4026 1213 00				
14	4026 0914 00	4026 1214 00				
15	4026 0915 00	4026 1215 00				
16	4026 0916 00	4026 1216 00				
17	4026 0917 00	4026 1217 00				
18	4026 0918 00	4026 1218 00	4026 1918 00	A		
19	4026 0919 00	4026 1219 00	4026 1919 00	A		
21		4026 1221 00	4026 1921 00	A		
22		4026 1222 00	4026 1922 00	A		
24		4026 1224 00	4026 1924 00	A	4026 2524 00	C
27		4026 1227 00	4026 1927 00	A	4026 2527 00	C
30			4026 1930 00	A	4026 2530 00	C
32			4026 1932 00	A	4026 2532 00	C
34			4026 1934 00	A	4026 2534 00	C
36			4026 1936 00	A	4026 2536 00	C
41					4026 2541 00	C
46					4026 2546 00	C
50					4026 2550 00	C
55					4026 2555 00	C
60					4026 2560 00	C
65					4026 2565 00	C
70						
75						
80 in						
5/16	4026 0908 00					
3/8	4026 1012 00	4026 1312 00				
13/32	4026 0910 00					
7/16	4026 0911 00	4026 1211 00				
15/32	4026 0912 00					
1/2	4026 1016 00	4026 1316 00				
9/16	4026 1018 00	4026 1318 00				
3/4	4026 0919 00	4026 1219 00	4026 1919 00	A		
15/16		4026 1224 00	4026 1924 00	A	4026 2524 00	C
1 1/8		4026 1336 00	4026 2036 00	A	4026 2636 00	
1 5/16			4026 2042 00	A	4026 2642 00	
1 1/2			4026 2048 00	A	4026 2648 00	

UNIVERSAL JOINTS

Male Square in	Square drive in	Length mm	Ordering No.	Pin and O-ring ref letter
3/8	3/8	60	4023 1182 00	
1/2	1/2	76	4023 0745 00	
3/4	3/4	89	4023 0857 00	B
1	1	112	4023 1060 00	C

SOCKET ADAPTERS

Male Square in	Square drive in	Length mm	Ordering No.	Pin and O-ring ref letter
1/2	3/8	35	4023 1153 00	
3/8	1/2	39	4023 1154 00	
1/2	3/4	57	4023 0909 00	A
1	3/4	65	4023 1157 00	B
3/4	1	75	4023 0868 00	C

LOCKING PIN AND O-RINGS

Ref letter	Ordering No.
A	4026 5000 90
B	4026 5000 91
C	4026 5000 92

EXTENSIONS

Male Square in	Square drive in	Length mm	Ordering No.	Pin and O-ring ref letter
3/8	3/8	152	4023 1164 06	
1/2	1/2	127	4023 0734 00	
1/2	1/2	254	4023 0735 00	
3/4	3/4	178	4023 0854 00	A
3/4	3/4	330	4023 0855 00	A
1	1	178	4023 0751 00	C
1	1	330	4023 0867 00	C

TORSION BAR

Width across flats mm	Length mm	Torque Nm	Ordering No.
17	215	95	4023 1284 00
19	215	90	4023 1286 00
19	215	120	4023 1287 00
21	215	100	4023 1303 00



Screwdrivers

For unmatched precision fastening, use PRO screwdrivers. These highly engineered fastening tools meet the demands for industrial performance, accuracy and durability.

Four different clutch types are available: impact drive, direct drive, slip clutch and shut-off coupling. Well-balanced for ergonomics, PRO screwdrivers take productivity to a whole new level.



Screwdriver selection guide

Type	Machine screw 4.8	Machine screw 8.8	Thread rolling screw-M	Thread forming screw-ST	Thread forming screw-ST, plastic	Self drilling screw-S	Wood screw
Impact clutch	Recommended	Recommended	Recommended	Recommended	Not recommended	Recommended	Recommended
Direct drive	OK	OK	OK	OK	Not recommended	Recommended	Recommended
Slip clutch	OK	OK	OK	Recommended	OK	Recommended	Recommended
Shut-off clutch	Recommended	Recommended	Recommended	OK	Recommended	OK	Not recommended

Recommended

OK

Not recommended



SCREWDRIVERS

For fast assembly and disassembly, PRO Impact Drive Screwdrivers with double hammer get the job done. Designed for the ultimate in operator

comfort, these lightweight tools deliver exceptional performance. Both models are reversible with a simple flip off lever on the side of the tool shaft.

PRO S2480 IMPACT DRIVE

Chuck size	1/4" Hex QC
Clutch type	Double hammer
Capacity	M5
Torque range	6-13 Nm
Max torque	20 Nm
Speed	6 500 r/min
Weight	0.78 kg
Length	132 mm
Vibration level	p. 52-54
Sound level	p. 52-54
Air consumption	10 l/s
Suitable air hose	6.3 mm (1/4")
Air inlet thread	1/4" BSP
Ordering No.	8431 0257 90



PRO S2481 IMPACT DRIVE

Chuck size	1/4" Hex QC
Clutch type	Double hammer
Capacity	M6
Torque range	11-20 Nm
Max torque	28 Nm
Speed	5 000 r/min
Weight	0.88 kg
Length	143 mm
Vibration level	p. 52-54
Sound level	p. 52-54
Air consumption	8 l/s
Suitable air hose	6.3 mm (1/4")
Air inlet thread	1/4" BSP
Ordering No.	8431 0257 92



PRO Direct Drive Screwdrivers stall when they reach max torque and are well suited for self-

drilling screws and wood screws.

PRO S2305 DIRECT DRIVE

Chuck size	1/4" Hex QC
Capacity	M8
Wood screw	No 12
Torque range	-12 Nm
Speed	750 r/min
Weight	0.9 kg
Length	198 mm
Vibration level	p. 52-54
Sound level	p. 52-54
Air consumption	5.6 l/s
Suitable air hose	6.3 mm (1/4")
Air inlet thread	1/4" BSP
Ordering No.	8431 0257 28



PRO S2326 DIRECT DRIVE

Chuck size	1/4" Hex QC
Capacity	M6
Wood screw	No 8
Torque range	-4.5 Nm
Speed	2 400 r/min
Weight	0.8 kg
Length	178 mm
Vibration level	p. 52-54
Sound level	p. 52-54
Air consumption	5.6 l/s
Suitable air hose	6.3 mm (1/4")
Air inlet thread	1/4" BSP
Ordering No.	8431 0257 36





SCREWDRIVERS

PRO Slip-Clutch Screwdrivers provide an implied pulsating force, or "slips", once you reach the desired torque. Top features include adjustable torque settings, wings for comfort, trigger and push start for pistol grips, and

lever and push start for straight models. These screwdrivers are suitable for soft joints or when the torque level may temporarily peak during the homing phase when using sheet metal screws, wood screws or self-tapping screws.



PRO S2308-C SLIP CLUTCH

Chuck size	1/4" Hex QC
Capacity	M6
Torque range	2.5-11 Nm
Speed	950 r/min
Weight	1.1 kg
Length	225 mm
Vibration level	p. 52-54
Sound level	p. 52-54
Air consumption	8.4 l/s
Suitable air hose	10 mm (3/8")
Air inlet thread	1/4" BSP
Ordering No.	8431 0257 20



PRO S2309-C SLIP CLUTCH

Chuck size	1/4" Hex QC
Capacity	M5
Torque range	1.5-7.5 Nm
Speed	1 200 r/min
Weight	1 kg
Length	245 mm
Vibration level	p. 52-54
Sound level	p. 52-54
Air consumption	7 l/s
Suitable air hose	10 mm (3/8")
Air inlet thread	1/4" BSP
Ordering No.	8431 0257 22



PRO S2340-C SLIP CLUTCH

Chuck size	1/4" Hex QC
Capacity	M3
Torque range	0.5-2 Nm
Speed	1 300 r/min
Weight	0.9 kg
Length	250 mm
Vibration level	p. 52-54
Sound level	p. 52-54
Air consumption	4.0 l/s
Suitable air hose	6.3 mm (1/4")
Air inlet thread	1/4" BSP
Ordering No.	8431 0257 40



PRO S2370-C SLIP CLUTCH

Chuck size	1/4" Hex QC
Capacity	M5
Torque range	2-6 Nm
Speed	1 300 r/min
Weight	0.9 kg
Length	250 mm
Vibration level	p. 52-54
Sound level	p. 52-54
Air consumption	4.0 l/s
Suitable air hose	6.3 mm (1/4")
Air inlet thread	1/4" BSP
Ordering No.	8431 0257 70



PRO Shut-off Screwdrivers have fast and accurate shut-off clutch for smooth performance and

high quality tightening. They are ideal for joints which require high accuracy in torque.

PRO S2450-P SHUT-OFF

Chuck size	1/4" Hex QC
Capacity	M5
Torque range	2.4-5 Nm
Speed	1 100 r/min
Weight	1.1 kg
Length	225 mm
Vibration level	p. 52-54
Sound level	p. 52-54
Air consumption	6.0 l/s
Suitable air hose	10 mm (3/8")
Air inlet thread	1/4" BSP
Ordering No.	8431 0257 84



PRO S2451-P SHUT-OFF

Chuck size	1/4" Hex QC
Capacity	M5
Torque range	3.5-7.5 Nm
Speed	800 r/min
Weight	1.1 kg
Length	250 mm
Vibration level	p. 52-54
Sound level	p. 52-54
Air consumption	7 l/s
Suitable air hose	10 mm (3/8")
Air inlet thread	1/4" BSP
Ordering No.	8431 0257 86



PRO S2452-P SHUT-OFF

Chuck size	1/4" Hex QC
Capacity	M6
Torque range	3.5-12 Nm
Speed	580 r/min
Weight	1.1 kg
Length	250 mm
Vibration level	p. 52-54
Sound level	p. 52-54
Air consumption	7 l/s
Suitable air hose	10 mm (3/8")
Air inlet thread	1/4" BSP
Ordering No.	8431 0257 87



PRO S2416-L SHUT-OFF

Chuck size	1/4" Hex QC
Capacity	M3
Torque range	0.5-1.6 Nm
Speed	1 500 r/min
Weight	0.9 kg
Length	230 mm
Vibration level	p. 52-54
Sound level	p. 52-54
Air consumption	6.0 l/s
Suitable air hose	10 mm (3/8")
Air inlet thread	1/4" BSP
Ordering No.	8431 0257 82



PRO S2426-L SHUT-OFF





Chuck size	1/4" Hex QC
Capacity	M4
Torque range	1.2-2.6 Nm
Speed	1 500 r/min
Weight	0.9 kg
Length	230 mm
Vibration level	p. 52-54
Sound level	p. 52-54
Air consumption	6.0 l/s
Suitable air hose	10 mm (3/8")
Air inlet thread	1/4" BSP
Ordering No.	8431 0257 80



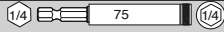



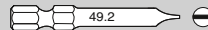

ACCESSORIES - SCREWDRIVERS

	Type		Ordering No.
Holder for insert bits	Magnetic holder		4023 0707 00

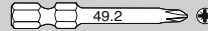
UNIVERSAL JOINTS		
	Size	Ordering No.
Slotted 	Blade width mm	Extra hard
	3.4	4023 1400 21
	3.9	4023 1400 22
	4.7	4023 1400 23
	5.5	4023 1400 26
	6.3	4023 1400 27
	7.0	4023 1400 28
Phillips 	Point size	Extra hard
	1	4023 0696 01
	2	4023 0697 01
	3	4023 0698 01
Pozidriv 	Point size	Extra hard
	1	4023 1101 11
	2	4023 1101 12
	3	4023 1101 13
Torx 	Point size	Medium hard
	T10	4023 1321 00
	T15	4023 1331 00
	T20	4023 1322 00
	T25	4023 1332 00
	T30	4023 1323 00
Allen head 	mm/in	Extra hard
	3	4023 0819 00
	4	4023 1320 00
	5/32	4023 0705 00
	5	4023 0820 00
	6	4023 0821 00

POWER BITS 1/4"		
	Size	Ordering No.
Slotted 	Blade width mm	Extra hard
	4.7	4023 2020 24
	6.3	4023 2020 26
	7.0	4023 2020 27
	7.9	4023 2020 28
	9.1	4023 2020 29
	Phillips 	Point size
1		4023 2320 21
2		4023 2320 22
3		4023 2320 23
Pozidriv 	Point size	Extra hard
	1	4023 2420 21
	2	4023 2420 22
	3	4023 2420 23
Torx 	Point size	Medium hard
	T10	4023 2220 23
	T15	4023 2220 24
	T20	4023 2220 25
	T25	4023 2220 26
	T30	4023 2220 28
Allen head 	mm/in	Extra hard
	3	4023 0710 00
	4	4023 0711 00
	5/32	4023 0681 00
	5	4023 0712 00
	6	4023 0906 00



Drills

Strong and robust, PRO drills deliver superior hole quality for demanding applications. Highly accurate and efficient, these tools offer unmatched speed, power, accuracy

and smooth silent-running operation. Features include air exhaust through the handle and an ergonomic handle for working comfort.



Choose the right drill for the right material

Material/cutting speed							
Model	r/min	Mild steel 20-30 m/min	Alloy steel 5-15 m/min	Cast iron 15-20 m/min	Aluminium and bronze 50-80 m/min	Wood and board 80-150 m/min	Composite 50-100 m/min
D2112	5 400	1.0- 2.0	-	-	2.5- 5.0	4.0- 8.0 ^a	1.0- 5.0
D2116 / D2160	2 400	2.5- 6.0	1.0- 3.0	2.0- 4.0	8.0-13.0 ^a	8.0-13.0 ^a	-
D2163	2 000	2.5- 6.0	1.0- 3.0	2.0- 4.0	8.0-13.0 ^a	8.0-13.0 ^a	-
D2121	750	8.0-13.0	3.0- 8.0	7.0-13.0	-	-	-
D2148-R	750	8.0-13.0	3.0- 8.0	7.0-13.0	-	-	-

a) Drill size larger than standard chuck capacity.

PRO D2112



Chuck capacity	0-6.5 mm
Mount	3/8"-24 UNF
Output	350 W
Speed	5 400 r/min
Weight	1.0 kg
Length incl chuck	206 mm
Vibration level	p. 52-54
Sound level	p. 52-54
Air consumption	10.0 l/s
Suitable air hose	10 mm (3/8")
Air inlet thread	1/4" BSP
Ordering No.	8421 0405 05

PRO D2116



Chuck capacity	1.5-10 mm
Mount	3/8"-24 UNF
Output	350 W
Speed	2 400 r/min
Weight	1.0 kg
Length incl chuck	211 mm
Vibration level	p. 52-54
Sound level	p. 52-54
Air consumption	10.0 l/s
Suitable air hose	10 mm (3/8")
Air inlet thread	1/4" BSP
Ordering No.	8421 0405 13

DRILLS

PRO D2121



Chuck capacity	2-13 mm
Mount	3/8"-24 UNF
Output	340 W
Speed	750 r/min
Weight	1.4 kg
Length incl chuck	248 mm
Vibration level	p. 52-54
Sound level	p. 52-54
Air consumption	10.0 l/s
Suitable air hose	10 mm (3/8")
Air inlet thread	1/4" BSP
Ordering No.	8421 0405 21

PRO D2148-R Reversible



Chuck capacity	2-13 mm
Mount	3/8"-24 UNF
Output	250 W
Speed	750 r/min
Weight	1.45 kg
Length incl chuck	248 mm
Vibration level	p. 52-54
Sound level	p. 52-54
Air consumption	10.0 l/s
Suitable air hose	10 mm (3/8")
Air inlet thread	1/4" BSP
Ordering No.	8421 0407 03

PRO D2160



Chuck capacity	1.5-10 mm
Mount	3/8"-24 UNF
Output	460 W
Speed	2 400 r/min
Weight	0.85 kg
Length incl chuck	234 mm
Vibration level	p. 52-54
Sound level	p. 52-54
Air consumption	11 l/s
Suitable air hose	10 mm (3/8")
Air inlet thread	1/4" BSP
Ordering No.	8421 0410 16

PRO D2163



Chuck capacity	1.5-10 mm
Mount	3/8"-24 UNF
Output	330 W
Speed	2 000 r/min
Weight	1.1 kg
Length incl chuck	242 mm
Height incl chuck	128 mm
Vibration level	p. 52-54
Sound level	p. 52-54
Air consumption	9.3 l/s
Suitable air hose	10 mm (3/8")
Air inlet thread	1/4" BSP
Ordering No.	8421 0410 08

Optional accessories for D2163 / D2160

	Ordering No.
Exhaust air hose	4150 1077 80
Support handle	4110 1355 85

Optional accessories for all drills

Key chucks, key included, mount 3/8"-24 UNF	Ordering No.		Ordering No.
Chuck capacity 0-6.5 mm (Standard with D2112)	4021 0444 00	Quick-change chuck for 1/4" bits mount 3/8"-24 UNF	4021 0443 00
Chuck capacity 1.5-10 mm (Standard with D2116, D2163)	4021 0446 00	Drill depth stop	4110 1370 80
		Drill depth stop for support handle	4110 1355 81
Chuck capacity 2-13 mm (Standard with D2121, D2148-R)	4021 0447 00	Exhaust air hose	4210 2053 00
		Use in/for D2112 D2116 D2121	
Keyless chuck 1-10 mm (Standard with D2112Q, D2116Q)	4021 0497 90	D2148-R Exhaust air hose	4210 2929 00
		D2112, D2116, D2121	
Keyless chuck 1.5-13 mm (Standard with D2121Q, D2148-RQ)	4021 0496 90		



DRILLS - QUICK CHANGE CHUCKS

PRO D2112Q



Chuck capacity	1-10 mm
Mount	3/8"-24 UNF
Output	350 W
Speed	5 400 r/min
Weight	1.0 kg
Length incl chuck	211 mm
Vibration level	p. 52-54
Sound level	p. 52-54
Air consumption	10 l/s
Suitable air hose	10 mm (3/8")
Air inlet thread	1/4" BSP
Ordering No.	8421 0405 10

PRO D2116Q



Chuck capacity	1-10 mm
Mount	3/8"-24 UNF
Output	350 W
Speed	2 400 r/min
Weight	1.0 kg
Length incl chuck	211 mm
Vibration level	p. 52-54
Sound level	p. 52-54
Air consumption	10 l/s
Suitable air hose	10 mm (3/8")
Air inlet thread	1/4" BSP
Ordering No.	8421 0405 15

PRO D2121Q



Chuck capacity	1.5-13 mm
Mount	3/8"-24 UNF
Output	340 W
Speed	750 r/min
Weight	1.4 kg
Length incl chuck	248 mm
Vibration level	p. 52-54
Sound level	p. 52-54
Air consumption	10 l/s
Suitable air hose	10 mm (3/8")
Air inlet thread	1/4" BSP
Ordering No.	8421 0405 25

PRO D2148-RQ



Chuck capacity	1.5-13 mm
Mount	3/8"-24 UNF
Output	250 W
Speed	750 r/min
Weight	1.45 kg
Length incl chuck	248 mm
Vibration level	p. 52-54
Sound level	p. 52-54
Air consumption	10 l/s
Suitable air hose	10 mm (3/8")
Air inlet thread	1/4" BSP
Ordering No.	8421 0407 05

PRO D2160-Q



Chuck capacity	1.5-10 mm
Mount	3/8"-24 UNF
Output	460 W
Speed	2 400 r/min
Weight	0.85 kg
Length incl chuck	234 mm
Vibration level	p. 52-54
Sound level	p. 52-54
Air consumption	11 l/s
Suitable air hose	10 mm (3/8")
Air inlet thread	1/4" BSP
Ordering No.	8421 0410 20

PRO D2163-Q



Chuck capacity	1.5-10 mm
Mount	3/8"-24 UNF
Output	330 W
Speed	2 000 r/min
Weight	1.1 kg
Length incl chuck	242 mm
Height incl chuck	128 mm
Vibration level	p. 52-54
Sound level	p. 52-54
Air consumption	9.3 l/s
Suitable air hose	10 mm (3/8")
Air inlet thread	1/4" BSP
Ordering No.	8421 0410 15

Optional accessories for D2163-Q / D2160-Q

	Ordering No.
Exhaust air hose	4150 1077 80
Support handle	4110 1355 85



Angle and Vertical Grinders

For high quality finishing and general surface preparation, PRO grinders are durable, lightweight and easy to handle. Choose from a range of angle and vertical grinders. Use these

powerful tools with depressed centre wheels, cut-off wheels or flap wheels from 100 mm up to 180 mm for optimal r/min. PRO G2510-series have built-in speed governors.



ANGLE GRINDERS

With unequalled power-to-weight ratio, the G25-series is the most powerful one-hand angle grinder in the PRO range. The back piece is adjustable to provide easy access to tight spaces.

New! Available - July 1 - 2010

PRO G2515

With speed governor
and overspeed shut-off

Speed	8 400 rpm
Output	1.3 kW
Max wheel diam	180 mm (7")
Spindle thread	5/8" UNC
Vibration level	p. 52-54
Sound level	p. 52-54
Length	353 mm
Weight	3.2 kg
Air consumption	19 l/s
Air inlet thread	3/8" BSP
Suitable air hose	13 mm (1/2")
Ordering No.	8423 0316 05



PRO G2510

With speed governor

Model	G2510-100	G2510-115	G2510-125
Speed	13 300 r/min	12 000 r/min	12 000 r/min
Output	800 W	800 W	800 W
Max wheel diam	100 mm (4")	115 mm (4 1/2")	125 mm (5")
Spindle thread	3/8"	M14	M14
Vibration level	p. 52-54	p. 52-54	p. 52-54
Sound level	p. 52-54	p. 52-54	p. 52-54
Length	207 mm	207 mm	207 mm
Weight	1.6 kg	1.6 kg	1.6 kg
Air consumption	17 l/s	17 l/s	17 l/s
Air inlet thread	3/8" BSP	3/8" BSP	3/8" BSP
Suitable air hose	13 mm (1/2")	13 mm (1/2")	13 mm (1/2")
Ordering No.	8423 0316 02	8423 0316 01	8423 0316 00





ANGLE GRINDERS



PRO G2408

Model	G2408-100	G2408-115	G2408-125
Speed	12 000 r/min	12 000 r/min	12 000 r/min
Output	350 W	350 W	350 W
Max wheel diam	100 mm (4")	115 mm (4 ½")	125 mm (5")
Spindle thread	3/8"-24 UNF	3/8"-24 UNF	3/8"-24 UNF
Vibration level	p. 52-54	p. 52-54	p. 52-54
Sound level	p. 52-54	p. 52-54	p. 52-54
Length	225 mm	225 mm	225 mm
Weight	0.9 kg	0.9 kg	0.9 kg
Air consumption	13.1 l/s	13.1 l/s	13.1 l/s
Air inlet thread	1/4" BSP	1/4" BSP	1/4" BSP
Suitable air hose	10 mm (3/8")	10 mm (3/8")	10 mm (3/8")
Ordering No.	8423 0314 60	8423 0314 78	8423 0314 80

Exhaust air hoses

Model	Ordering No.
G2408	4150 1077 80
G2510	4150 1532 01

Adapter

Model	Ordering No.
UNF 3/8"-24 x M14	4021 0435 00

Vibration damped handle

Model	Ordering No.
G2408	4150 1521 80
G2510	4150 1521 80

VERTICAL GRINDERS



PRO G2415

With speed governor

Speed	8 500 r/min
Output	1 100 W
Max wheel diam	180 mm (7")
Max cup wheel	100 mm (4")
Max wire brush	-
Spindle thread	5/8"-11 UNC
Vibration level	p. 52-54
Sound level	p. 52-54
Height	198 mm
Length	280 mm
Weight	2.65 kg
Air consumption	21 l/s
Air inlet thread	1/2" BSP
Suitable air hose	13 mm (1/2")
Ordering No.	8423 2522 49



PRO G2416

With speed governor

Speed	6 000 r/min
Output	900 W
Max wheel diam	180 mm (7")
Max cup wheel	125 mm (4")
Max wire brush	140 mm (5½")
Spindle thread	5/8"-11 UNC
Vibration level	p. 52-54
Sound level	p. 52-54
Height	198 mm
Length	280 mm
Weight	2.65 kg
Air consumption	18 l/s
Air inlet thread	1/2" BSP
Suitable air hose	13 mm (1/2")
Ordering No.	8423 2522 56

Optional accessories - Vertical grinders

Accessories included for G2415, G2416



Attachment set for reinforced cut-off wheel
Ordering No.
4170 1133 87

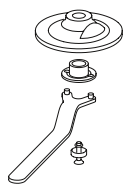

Attachment set for depressed centre wheel
Ordering No.
4170 0219 87

Optional accessories for G2415, G2416

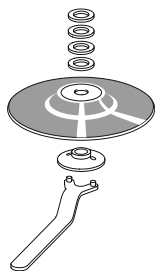

180 mm soft pad with spanner and lock nut
Ordering No.
4170 0756 80

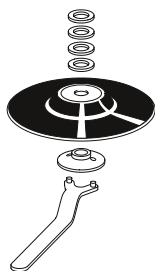

180 mm stiff pad with spanner and lock nut
Ordering No.
4170 0757 80

Optional accessories for G2416

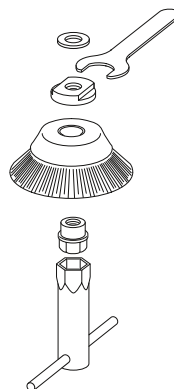

Attachment set for steel wire brush Ø 115 mm
Ordering No.
4170 0459 81

Steel wire brush Ø 115 mm
Ordering No.
4170 0491 00

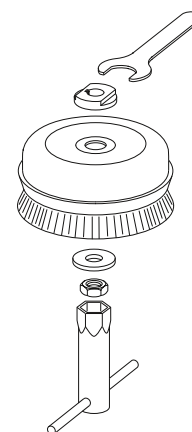

Attachment set for steel wire brush Ø 140 mm
Ordering No.
4170 0550 80

Steel wire brush Ø 140 mm
Ordering No.
4170 0685 00



Die Grinders

Powerful yet lightweight, PRO die grinders make easy work of fine grinding and finishing as well as buffing and rough finishing. Check out the smooth operation of the G2414 and

G2424 series with unique suspension that prevents burr chatter and minimizes vibration transfer. The G2414 and G2424 series are also equipped with speed governors.

DIE GRINDERS

PRO G2412

Model	G2412-1	G2412-2
Speed	20 000 r/min	20 000 r/min
Collet	6 mm	1/4"
Output	350 W	350 W
Length	178 mm	178 mm
Vibration level	p. 52-54	p. 52-54
Sound level	p. 52-54	p. 52-54
Weight	0.5 kg	0.5 kg
Air consumption	10.3 l/s	10.3 l/s
Air inlet thread	1/4" BSP	1/4" BSP
Suitable air hose	10 mm (3/8")	10 mm (3/8")
Ordering No.	8423 0312 21	8423 0312 39



PRO G2440

Speed	4 300 r/min
Collet	6 mm & 1/4"
Output	550 W
Length	216 mm
Vibration level	p. 52-54
Sound level	p. 52-54
Weight	0.9 kg
Air consumption	5.7 l/s
Air inlet thread	1/4" BSPT
Suitable air hose	10 mm
Ordering No	8423 0312 20



PRO G2445

Speed	15 000 r/min
Collet	6 mm & 1/4"
Output	255 W
Length	188 mm
Vibration level	p. 52-54
Sound level	p. 52-54
Weight	0.7 kg
Air consumption	6.7 l/s
Air inlet thread	1/4" BSPT
Suitable air hose	10 mm
Ordering No	8423 0312 80



PRO G2414

With speed governor and suspension

Model	G2414 S080	G2414 S120	G2414 S150	G2414 S200	G2414 S250
Speed	8 000 r/min	12 000 r/min	15 000 r/min	20 000 r/min	25 000 r/min
Collet	6 mm & 1/4"	6 mm & 1/4"	6 mm & 1/4"	6 mm & 1/4"	6 mm & 1/4"
Output	500 W	750 W	850 W	900 W	950 W
Length	215 mm	215 mm	215 mm	215 mm	215 mm
Vibration level	p. 52-54	p. 52-54	p. 52-54	p. 52-54	p. 52-54
Sound level	p. 52-54	p. 52-54	p. 52-54	p. 52-54	p. 52-54
Weight	0.78 kg	0.78 kg	0.78 kg	0.78 kg	0.78 kg
Air consumption	4.2 l/s	5.3 l/s	7.2 l/s	9 l/s	14.5 l/s
Air inlet thread	3/8" BSP	3/8" BSP	3/8" BSP	3/8" BSP	3/8" BSP
Suitable air hose	13 mm (1/2")	13 mm (1/2")	13 mm (1/2")	13 mm (1/2")	13 mm (1/2")
Ordering No.	8423 0312 58	8423 0312 57	8423 0312 56	8423 0312 30	8423 0312 29





EXTENDED DIE GRINDERS

PRO G2422

Model	G2422-1	G2422-2
Speed	20 000 r/min	20 000 r/min
Collet	6 mm	1/4"
Output	350 W	350 W
Length	277 mm	277 mm
Vibration level	p. 52-54	p. 52-54
Sound level	p. 52-54	p. 52-54
Weight	0.7 kg	0.7 kg
Air consumption	10.3 l/s	10.3 l/s
Air inlet thread	1/4" BSP	1/4" BSP
Suitable air hose	10 mm (3/8")	10 mm (3/8")
Ordering No.	8423 0312 47	8423 0312 54



p. 52-54

PRO G2424

With speed governor and suspension

Model	G2424 S080	G2424 S120	G2424 S150	G2424 S200	G2424 S250
Speed	8 000 r/min	12 000 r/min	15 000 r/min	20 000 r/min	25 000 r/min
Collet	6 mm & 1/4"	6 mm & 1/4"	6 mm & 1/4"	6 mm & 1/4"	6 mm & 1/4"
Output	440 W	700 W	750 W	850 W	900 W
Length	315 mm	315 mm	315 mm	315 mm	315 mm
Vibration level	p. 52-54	p. 52-54	p. 52-54	p. 52-54	p. 52-54
Sound level	p. 52-54	p. 52-54	p. 52-54	p. 52-54	p. 52-54
Weight	0.96 kg	0.96 kg	0.96 kg	0.96 kg	0.96 kg
Air consumption	4.2 l/s	5.3 l/s	7.2 l/s	9 l/s	14.5 l/s
Air inlet thread	3/8" BSP	3/8" BSP	3/8" BSP	3/8" BSP	3/8" BSP
Suitable air hose	13 mm (1/2")	13 mm (1/2")	13 mm (1/2")	13 mm (1/2")	13 mm (1/2")
Ordering No.	8423 0312 61	8423 0312 60	8423 0312 59	8423 0312 55	8423 0312 62



PRO G2451

Collet	1/8" & 3 mm
Output	80 W
Max speed	80 000 r/min
Weight	0.48 kg
Length	140 mm
Air inlet	1/4" BSP
Hose size	5 mm
Sound level	p. 52-54
Vibration	p. 52-54
Ordering No.	8423 0313 01



Optional accessories for G2412, G2414, G2422, G2424

Collet chuck complete	Ordering No.
3 mm	4150 1049 81
6 mm	4150 1049 83
8 mm	4150 1049 84
1/8"	4150 1049 85
1/4"	4150 1049 88



Sanders

PRO's range of sanding and polishing tools deliver surface finishing at its best. For rough surface sanding, choose pistol grip sanders and

belt sanders. Random orbital sanders fit the bill for coarse and fine sanding. For optimal surface polishing, angle grinders get the job done.



SANDERS

With unequalled power-to-weight ratio, the G2510-series is the most powerful angle sander in the PRO range. Choose between two different rotational speeds for surface grinding with various grits.



PRO G2510 With speed governor

	S066	S085	S066-M14	S085-M14
Speed	6 600 r/min	8 500 r/min	6 600 r/min	8 500 r/min
Output	800 W	800 W	800 W	800 W
Recommended pad size	180 mm	180 mm	180 mm	180 mm
Spindle thread	UNC 5/8"	UNC 5/8"	M14	M14
Vibration level	p. 52-54	p. 52-54	p. 52-54	p. 52-54
Sound level	p. 52-54	p. 52-54	p. 52-54	p. 52-54
Length	207 mm	207 mm	207 mm	207 mm
Weight	1.4 kg	1.4 kg	1.4 kg	1.4 kg
Air consumption	17 l/s	17 l/s	17 l/s	17 l/s
Air inlet thread	3/8" BSP	3/8" BSP	3/8" BSP	3/8" BSP
Suitable air hose	13 mm (1/2")	13 mm (1/2")	13 mm (1/2")	13 mm (1/2")
Ordering No.	8423 0316 39	8423 0316 35	8423 0316 40	8423 0316 41

Accessories for G2510 S066 / S085 / S066-M14 / S085-M14



Spot suction kit for 125 mm disc with flow chamber, cap, washers, backing pad, nut and spanner.

Ordering No. 3780 4008 86

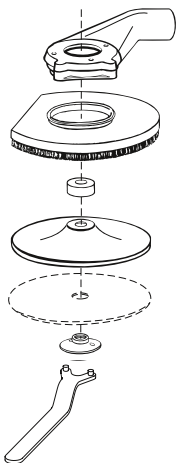

Spot suction kit for 180 mm disc with flow chamber, cap, washers, backing pad, nut and spanner.

Ordering No. 3780 4008 87

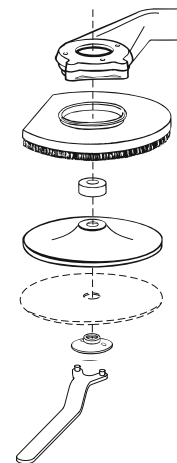

Accessories for G2510 S066 / S085 (Only available with 5/8"-11 UNC thread)

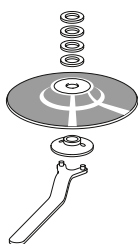

125 mm soft pad with spanner and lock nut

Ordering No. 4170 0768 80

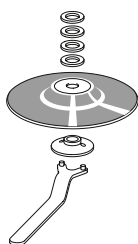

180 mm soft pad with spanner and lock nut

Ordering No. 4170 0756 80

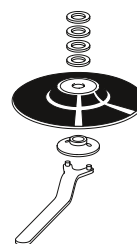

125 mm stiff pad with spanner and lock nut

Ordering No. 4170 0757 80



SANDERS

Enjoy a complete line of pistol grip sanders that handle virtually every need. Choose from the G2302 mini-pistol sander up to the powerful G2502 sander with pad sizes ranging from 50 mm (2") to 125 mm (5"). G2302 pads work with the Roloc system. All PRO sanders feature adjustable speed controlled by the trigger and air exhaust through the handle.

PRO G2302 Kit

Complete set with 2" and 3" backup pads. 10 of each sanding discs 60-80-120 grit for 2" and 3", 3 of each 2" and 3" surface preparation pads (fine, medium and coarse).

Speed	17 000 r/min
Pad size	3" Roloc
Output	175 W
Length	109 mm
Vibration level	p. 52-54
Sound level	p. 52-54
Weight	0.6 kg
Air consumption	8.9 l/s
Air inlet thread	1/4" BSP
Suitable air hose	10 mm (3/8")
Ordering No.	8423 0312 15



PRO G2302

Speed	17 000 r/min
Pad size	3" Roloc
Spindel thread	1/4"-20 UNC
Output	175 W
Length	109 mm
Vibration level	p. 52-54
Sound level	p. 52-54
Weight	0.6 kg
Air consumption	8.9 l/s
Air inlet thread	1/4" BSP
Suitable air hose	10 mm (3/8")
Ordering No.	8423 0312 14



PRO G2502

Speed	12 000 r/min
Pad size	125 mm (5")
Spindel thread	7/16" UNF
Output	270 W
Length	108 mm
Vibration level	p. 52-54
Sound level	p. 52-54
Weight	1 kg
Air consumption	12 l/s
Air inlet thread	1/4" BSPT
Suitable air hose	10 mm (3/8")
Ordering No.	8423 0312 05





SANDERS

- Adjustable angle of arm • Air exhaust through handle.

PRO G2403



Rotational speed	18 000 r/min
Belt speed	1 300 m/min
Belt dimension	10 x 330 mm
Output	250 W
Length	280 mm
Vibration level	p. 52-54
Sound level	p. 52-54
Weight	0.8 kg
Air consumption	11 l/s
Air inlet thread	1/4" BSP
Suitable air hose	10 mm (3/8")
Ordering No.	8423 0304 33

PRO G2404



Rotational speed	16 500 r/min
Belt speed	2 540 m/min
Belt dimension	20 x 520 mm
Output	400 W
Length	360 mm
Vibration level	p. 52-54
Sound level	p. 52-54
Weight	1.4 kg
Air consumption	11 l/s
Air inlet thread	1/4" BSP
Suitable air hose	10 mm (3/8")
Ordering No.	8423 0304 44

Accessories belt sanders

Abrasives	G2403	G2404
50 grit	4170 1199 00	4170 1201 00
80 grit	4170 1196 00	4170 1197 00
120 grit	4170 1200 00	4170 1202 00

POLISHING SANDERS



PRO G2406

Speed	2 000 r/min
Output	350 W
Support pad	125-200 mm
Spindle thread	3/8"-24 UNF
Vibration level	p. 52-54
Sound level	p. 52-54
Length	300 mm
Weight	1.4 kg
Air consumption	10 l/s
Air inlet thread	1/4" BSP
Suitable air hose	10 mm (3/8")
Ordering No.	8423 0304 88



PRO G2407 / M14

Speed	3 400 r/min
Output	350 W
Support pad	125-200 mm
Spindle thread	3/8"-24 UNF
Vibration level	p. 52-54
Sound level	p. 52-54
Length	300 mm
Weight	1.4 kg
Air consumption	10 l/s
Air inlet thread	1/4" BSP
Suitable air hose	10 mm (3/8")
Ordering No.	8423 0304 77
	8423 0304 55 (M14)

Accessories for G2406



150 mm Velcro pad, thread UNC 5/8". Maximum speed 2 500 r/min. To be used together with velcrosponge heads or Velcro lamb's-wool bonnet.

Ordering No. 4112 6092 15



Lamb's-wool bonnet 150 mm with Velcro fitting. Maximum speed 2 500 r/min.

Ordering No. 4112 6093 15



150 mm Velcro sponge head, maximum speed 2 500 r/min, **White**, Dense, firm sponge head for compounding 2-pack paint systems. Excellent result with all leading makes of compound and polish.

Ordering No. 4112 6094 15



200 mm Velcro sponge head, maximum speed 2 500 r/min, **White**, Dense, firm sponge head for compounding 2-pack paint systems. Excellent result with all leading makes of compound and polish.

Ordering No. 4112 6095 20



150 mm Velcro sponge head, maximum speed 2 500 r/min, **Blue** Softer sponge, more open cell, for polishing and compounding of cellulose, acrylics etc.

Ordering No. 4112 6096 15



200 mm Velcro sponge head, maximum speed 2 500 r/min, **Blue** Softer sponge, more open cell, for polishing and compounding of cellulose, acrylics etc.

Ordering No. 4112 6097 20



150 mm Velcro sponge head, maximum speed 2 500 r/min, **Pink** Ultra soft, particularly good for dark colours.

Ordering No. 4112 6098 15



150 mm Velcro sponge head, maximum speed 2 500 r/min, **Yellow** coarse sponge, open cell, for aggressive compounding including oxidised paintwork.

Ordering No. 4112 6099 15

Accessories for G2406 and G2407



150 mm white sponge head pad, thread UNC 5/8". Maximum speed 4 000 r/min.

Ordering No. 4112 6100 15



150 mm blue sponge head pad, thread UNC 5/8". Maximum speed 4 000 r/min.

Ordering No. 4112 6101 15



180 mm soft plastic UNC 5/8" and spanner. Maximum speed 8 000 r/min.

Ordering No. 4170 0756 80



UNF 3/8"-24 x M14 Spindle thread adaptor. (To be used with M14 threaded accessories.)

Ordering No. 4021 0435 00



Exhaust air hose

Ordering No. 4150 1077 80



RANDOM ORBITAL SANDERS

For perfect coarse and fine sanding result, choose a lubrication-free PRO random orbital sander with 2.5, 5 or 10 mm orbit.

PRO G2438-N	G2438-6.3N	G2438-6.5N	G2438-6.10N
Without suction			
Speed	12 000 r/min	12 000 r/min	12 000 r/min
Output	160 W	160 W	160 W
Dia orbit	2.5 mm	5 mm	10 mm
Pad size	150 mm	150 mm	150 mm
Velcro pad	No hole version	No hole version	No hole version
Spindle thread	5/16" UNF	5/16" UNF	5/16" UNF
Vibration level	p. 52-54	p. 52-54	p. 52-54
Sound level	p. 52-54	p. 52-54	p. 52-54
Length	170 mm	170 mm	170 mm
Weight	0.9 kg	0.9 kg	0.9 kg
Air consumption	9 l/s	9 l/s	9 l/s
Air inlet thread	1/4" BSP	1/4" BSP	1/4" BSP
Suitable air hose	10 mm (3/8")	10 mm (3/8")	10 mm (3/8")
Ordering No.	8423 0313 10	8423 0313 05	8423 0313 12



PRO G2438-I	G2438-6.3I	G2438-6.5I	G2438-6.10I
Internal self suction, dust bag included			
Speed	12 000 r/min	12 000 r/min	12 000 r/min
Output	160 W	160 W	160 W
Dia orbit	2.5 mm	5 mm	10 mm
Pad size	150 mm	150 mm	150 mm
Velcro pad	6 hole version	6 hole version	6 hole version
Spindle thread	5/16" UNF	5/16" UNF	5/16" UNF
Vibration level	p. 52-54	p. 52-54	p. 52-54v
Sound level	p. 52-54	p. 52-54	p. 52-54
Length	235 mm	235 mm	235 mm
Weight	1.0 kg	1.0 kg	1.0 kg
Air consumption	9 l/s	9 l/s	9 l/s
Air inlet thread	1/4" BSP	1/4" BSP	1/4" BSP
Suitable air hose	10 mm (3/8")	10 mm (3/8")	10 mm (3/8")
Ordering No.	8423 0313 20	8423 0313 15	8423 0313 17



PRO G2438-C	G2438-6.3C	G2438-6.5C	G2438-6.10C
Central suction			
Speed	12 000 r/min	12 000 r/min	12 000 r/min
Output	160 W	160 W	160 W
Dia orbit	2.5 mm	5 mm	10 mm
Pad size	150 mm	150 mm	150 mm
Velcro pad	6 hole version	6 hole version	6 hole version
Spindle thread	5/16" UNF	5/16" UNF	5/16" UNF
Vibration level	p. 52-54	p. 52-54	p. 52-54
Sound level	p. 52-54	p. 52-54	p. 52-54
Length	215 mm	215 mm	215 mm
Weight	0.9 kg	0.9 kg	0.9 kg
Air consumption	9 l/s	9 l/s	9 l/s
Air inlet thread	1/4" BSP	1/4" BSP	1/4" BSP
Suitable air hose	10 mm (3/8")	10 mm (3/8")	10 mm (3/8")
Ordering No.	8423 0313 30	8423 0313 25	8423 0313 27





RANDOM ORBITAL SANDERS



PRO G2301

Speed	17 000 r/min
Dia orbit	4 mm
Pad size	3"
Output	175 W
Length	117 mm
Vibration level	p. 52-54
Sound level	p. 52-54
Weight	0.6 kg
Air consumption	8.9 l/s
Air inlet thread	1/4" BSP
Suitable air hose	10 mm (3/8")

Ordering No. 8423 0312 10

PRO G2301-KIT

Complete set with 1 pcs each of 2" and 3" velcro sanding pad and 10 pcs each of 320-400-600 grit sanding paper for 2" and 3".

Speed	17 000 r/min
Dia orbit	4 mm
Pad size	3"
Output	175 W
Length	117 mm
Vibration level	p. 52-54
Sound level	p. 52-54
Weight	0.6 kg
Air consumption	8.9 l/s
Air inlet thread	1/4" BSP
Suitable air hose	10 mm (3/8")

Ordering No. 8423 0312 11



PRO G2428 Two hand model

Speed	9 025 r/min
Dia orbit	10 mm
Pad size	150 mm
Velcro pad	6 hole version
Spindle thread	5/16" UNF
Vibration level	p. 52-54
Sound level	p. 52-54
Length	170 mm
Weight	1.5 kg
Air consumption	9 l/s
Air inlet thread	1/4" BSP
Suitable air hose	10 mm (3/8")

Ordering No. 8423 2810 16

Accessories, pads

125 mm for G2438	Ordering No.
125 mm Velcro 5 hole	4112 6106 04
125 mm Vinyl 5 hole	4112 6106 02
125 mm Vinyl no hole	4112 6106 01
125 mm Velcro no hole	4112 6106 03

Accessories, pads

150 mm for G2428	Ordering No.
150 mm Velcro 6 hole	4112 6103 16
150 mm Vinyl 6 hole	4112 6105 06
150 mm Velcro no hole	4112 6102 10
150 mm Vinyl no hole	4112 6104 00



Percussive Tools

Built to endure, PRO percussive tools handle the toughest jobs with ease. Simple, rugged designs deliver powerful, efficient and dynamic

force. Light and compact, these tools put power into your hands to get the job done effortlessly.



WELD FLUX CHIPPERS & SCALERS

PRO small weld flux chippers are ideal for applications such as light chipping, carving stone, scaling and removing paint, rust and, of course, weld flux. For the toughest jobs, the robust P2515A scaler does not disappoint. The needle scaler with 19 standard steel needles is perfect for removing welding slag, rust and paint from steel structures. With adjustable power, the P2505 engraving pen marks almost every surface and material, including glass, stone and metal, and comes with 1.8 meters of 3.2 mm PVC hose.

PRO Weld flux chippers

Model	P2520	P2521	P2522
Chisel shank	12.7 mm (1/2") sq	12.7 mm (1/2") sq	12.7 mm (1/2") sq
Blows	90 Hz	60 Hz	60 Hz
Piston stroke	16 mm	20 mm	20 mm
Vibration level	p. 52-54	p. 52-54	p. 52-54
Sound level	p. 52-54	p. 52-54	p. 52-54
Length	182 mm	204 mm	239 mm
Weight	1.0 kg	1.5 kg	1.7 kg
Air consumption	2.4 l/s	3.0 l/s	3.0 l/s
Air inlet thread	1/4" BSPT	1/4" BSPT	1/4" BSPT
Suitable air hose	6.3 mm (1/4")	6.3 mm (1/4")	10 mm (3/8")
Ordering No.	8425 0103 15	8425 0103 17	8425 0103 19



PRO P2515A Scaler

Chisel shank	12.7 mm (1/2") sq
Blows	66 Hz
Piston stroke	25 mm
Vibration level	p. 52-54
Sound level	p. 52-54
Length	228 mm
Weight	1.9 kg
Air consumption	2.5 l/s
Air inlet thread	1/4" BSP
Suitable air hose	10 mm (3/8")
Ordering No.	8425 0103 59



PRO P2516A Needle scaler

Blows	66 Hz
Piston stroke	25 mm
Vibration level	p. 52-54
Sound level	p. 52-54
Length	373 mm
Weight	2.6 kg
Air consumption	2.5 l/s
Air inlet thread	1/4" BSP
Suitable air hose	10 mm (3/8")
Ordering No.	8425 0103 67



PRO P2505 Engraving Pen

Blows	190 Hz
Vibration level	p. 52-54
Sound level	p. 52-54
Length	175 mm
Weight	0.12 kg
Air consumption	0.6 l/s
Air inlet thread	1/8" BSP
Suitable air hose	3.2 mm (1/8")
Ordering No.	8425 0102 72



Accessories for P2516A - needles

Set of 19 needle	Length mm	Ordering No.
Steel standard	180	3512 0071 90
Stainless Steel, flat ends	180	3512 0072 90
Beryllium copper flat ends	180	3512 0073 90

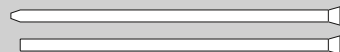

Accessories for P2505

	Ordering No.
Needle and small parts kit	4081 0068 90



CHIPPING HAMMERS

With a comfortable grip and controllable impact, PRO pistol grip chipping hammers are well suited for chipping, cutting, shearing and punching applications. The P2530 and P2531 versions can easily be adapted for riveting by mounting the rivet snap accessories.

PRO P2530-R



Chisel shank	10.2 mm round
Riveting capacity	3.2 mm aluminium
Riveting capacity	2.5 mm steel
Blows	60 Hz
Piston stroke	38 mm
Vibration level	p. 52-54
Sound level	p. 52-54
Length	140 mm
Weight	1.1 kg
Air consumption	5.8 l/s
Air inlet thread	1/4" BSPT
Suitable air hose	10 mm (3/8")
Ordering No.	8425 0206 16

PRO P2530-H



Chisel shank	10.2 mm hex
Blows	60 Hz
Piston stroke	38 mm
Vibration level	p. 52-54
Sound level	p. 52-54
Length	140 mm
Weight	1.1 kg
Air consumption	5.8 l/s
Air inlet thread	1/4" BSPT
Suitable air hose	10 mm (3/8")
Ordering No.	8425 0206 15

PRO P2531-R



Chisel shank	10.2 mm round
Riveting capacity	6.4 mm aluminium
Riveting capacity	5.0 mm steel
Blows	50 Hz
Piston stroke	44.5 mm
Vibration level	p. 52-54
Sound level	p. 52-54
Length	193 mm
Weight	1.5 kg
Air consumption	6.7 l/s
Air inlet thread	1/4" BSPT
Suitable air hose	10 mm (3/8")
Ordering No.	8425 0206 21

PRO P2531-H



Chisel shank	10.2 mm hex
Blows	50 Hz
Piston stroke	44.5 mm
Vibration level	p. 52-54
Sound level	p. 52-54
Length	193 mm
Weight	1.5 kg
Air consumption	6.7 l/s
Air inlet thread	1/4" BSPT
Suitable air hose	10 mm (3/8")
Ordering No.	8425 0206 20



CHIPPING HAMMERS

Powerful and robust, PRO chipping hammers are designed for the toughest jobs in foundries, heavy industry and demolition.



PRO P2535-R

Chisel shank	14 mm round
Blows	50 Hz
Piston stroke	44.5 mm
Length	273 mm
Weight	2.5 kg
Air consumption	7 l/s
Air inlet thread	1/4" BSPT
Suitable air hose	10 mm (3/8")
Ordering No.	8425 0206 31



PRO P2535-H

Chisel shank	12 mm hex
Blows	50 Hz
Piston stroke	44.5 mm
Length	273 mm
Weight	2.5 kg
Air consumption	7 l/s
Air inlet thread	1/4" BSPT
Suitable air hose	10 mm (3/8")
Ordering No.	8425 0206 30



PRO P2536-R

Chisel shank	17.5 mm round
Blows	50 Hz
Piston stroke	25 mm
Vibration level	p. 52-54
Length	301 mm
Weight	5.0 kg
Air consumption	10 l/s
Air inlet thread	3/8" BSPT
Suitable air hose	12.5 mm (1/2")
Ordering No.	8425 0206 36



PRO P2536-H

Chisel shank	17.5 mm hex
Blows	50 Hz
Piston stroke	25 mm
Vibration level	p. 52-54
Length	301 mm
Weight	5.0 kg
Air consumption	10 l/s
Air inlet thread	3/8" BSPT
Suitable air hose	12.5 mm (1/2")
Ordering No.	8425 0206 35



PRO P2539-H

Chisel shank	17.5 mm hex
Blows	28 Hz
Piston stroke	102 mm
Vibration level	p. 52-54
Length	425 mm
Weight	6.8 kg
Air consumption	10.8 l/s
Air inlet thread	3/8" BSPT
Suitable air hose	12.5 mm (1/2")
Ordering No.	8425 0206 50







ACCESSORIES CHIPPING HAMMERS

	Designation	Width	Length	For Tool	Ordering No.
	Chisel blank	15 mm	155 mm	P2515A	3085 0228 02
		13 mm	175 mm	P2525	3085 0212 00
		13 mm	200 mm	P2526	3085 0182 00
		13 mm	350 mm	P2526	3085 0182 01
	Flat chisel	15 mm	155 mm	P2515A	3085 0230 01
		20 mm	180 mm	P2515A	3085 0230 02
		16 mm	175 mm	P2525	3085 0265 00
		13 mm	200 mm	P2526	3085 0183 00
	Wide flat chisel	35 mm	165 mm	P2515A	3085 0232 01
	Sharp chisel	15 mm	175 mm	P2525	3085 0216 00
		15 mm	200 mm	P2526	3085 0170 00
		15 mm	300 mm	P2526	3085 0170 01
	Spot weld chisel	17 mm	175 mm	P2525	3085 0270 00
		17 mm	200 mm	P2526	3085 0301 00
	Angle scraper chisel	30 mm	200 mm	P2526	3085 0262 00
		30 mm	175 mm	P2525	3085 0264 00
		35 mm	165 mm	P2515A	3085 0362 00
	Moil point chisel	13 mm	200 mm	P2526	3085 0297 00
		13 mm	305 mm	P2526	3085 0297 01
	Pipe cutting chisel	35 mm	175 mm	P2525	3085 0268 00
		20 mm	200 mm	P2526	3085 0302 00
		35 mm	200 mm	P2526	3085 0303 00
	Plate cutting chisel	14.5 mm	175 mm	P2525	3085 0226 01
		14.5 mm	200 mm	P2526	3085 0263 00
	Plate cutting chisel	16 mm	175 mm	P2525	3085 0215 00
		16 mm	200 mm	P2526	3085 0173 00

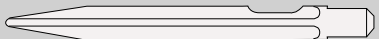
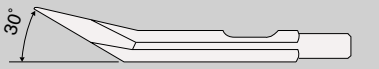
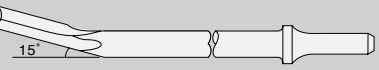
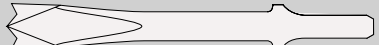
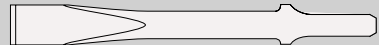

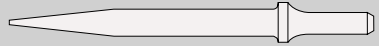
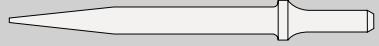
ACCESSORIES CHIPPING HAMMERS

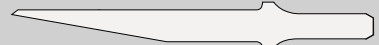
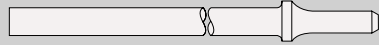
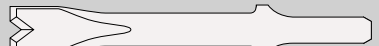
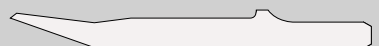
	Designation	Width	Length	For Tool	Ordering No.
	Chisel blank	12.7 mm	155 mm	P2520, P2521, P2522	3085 0400 00
		12.7 mm	200 mm	P2520, P2521, P2522	3085 0400 01
		12.7 mm	250 mm	P2520, P2521, P2522	3085 0400 02
	Flat chisel	15.5 mm	155 mm	P2520, P2521, P2522	3085 0400 03
		15.5 mm	200 mm	P2520, P2521, P2522	3085 0400 04
		15.5 mm	250 mm	P2520, P2521, P2522	3085 0400 05
	Flux chisel	25 mm	155 mm	P2520, P2521, P2522	3085 0400 06
		25 mm	200 mm	P2520, P2521, P2522	3085 0400 07
		25 mm	250 mm	P2520, P2521, P2522	3085 0400 08
	Plate cutting chisel	13 mm	208 mm	P2530-R, P2531-R	3085 0400 09
		13 mm	208 mm	P2530-H, P2531-H	3085 0400 10
	Double edge plate cutting chisel	19 mm	155 mm	P2530-R, P2531-R	3085 0400 11
		19 mm	155 mm	P2530-H, P2531-H	3085 0400 12
	Flat chisel	20 mm	178 mm	P2530-R, P2531-R	3085 0400 13
		20 mm	178 mm	P2530-H, P2531-H	3085 0400 14
	Point chisel	3.2 mm	178 mm	P2530-R, P2531-R	3085 0400 15
		3.2 mm	178 mm	P2530-H, P2531-H	3085 0400 16
	Rivet cutter	15 mm	150 mm	P2530-R, P2531-R	3085 0400 17
		15 mm	150 mm	P2530-H, P2531-H	3085 0400 18
	Chisel blank	12.7 mm	182 mm	P2530-R, P2531-R	3085 0400 19
		12.7 mm	182 mm	P2530-H, P2531-H	3085 0400 20
	Spot weld chisel	19 mm	145 mm	P2530-R, P2531-R	3085 0400 21
		19 mm	145 mm	P2530-H, P2531-H	3085 0400 22

ACCESSORIES CHIPPING HAMMERS



Designation	Width	Length	For Tool	Ordering No.
Rivet snap 3 Rivet size 3 mm		90 mm	P2530-R, P2531-R	3085 0400 23
Rivet snap 4 Rivet size 4 mm		90 mm	P2530-R, P2531-R	3085 0400 24
Rivet snap 5 Rivet size 5 mm		90 mm	P2530-R, P2531-R	3085 0400 25
Rivet snap 6 Rivet size 6 mm		90 mm	P2530-R, P2531-R	3085 0400 26
Chisel blank	16 mm	250 mm	P2535-R	3085 0400 27
	16 mm	300 mm	P2535-R	3085 0400 28
	16 mm	250 mm	P2535-H	3085 0400 29
	16 mm	300 mm	P2535-H	3085 0400 30
	20 mm	250 mm	P2536-R	3085 0400 31
	20 mm	300 mm	P2536-R	3085 0400 32
	20 mm	250 mm	P2536-H, P2539-H	3085 0400 33
	20 mm	300 mm	P2536-H, P2539-H	3085 0400 34
Flat chisel	16 mm	200 mm	P2535-R	3085 0400 35
	16 mm	200 mm	P2535-H	3085 0400 36
	20 mm	250 mm	P2536-R	3085 0400 37
	20 mm	250 mm	P2536-H, P2539-H	3085 0400 38
Point chisel	16 mm	200 mm	P2535-R	3085 0400 39
	16 mm	200 mm	P2535-H	3085 0400 40
	20 mm	250 mm	P2536-R	3085 0400 41
	20 mm	250 mm	P2536-H, P2539-H	3085 0400 42
Wide flat chisel	16 mm	200 mm	P2535-R	3085 0400 43
	16 mm	200 mm	P2535-H	3085 0400 44
	20 mm	250 mm	P2536-R	3085 0400 45
	20 mm	250 mm	P2536-H, P2539-H	3085 0400 46

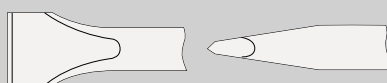
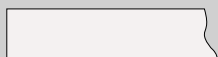



Hose Reels

PRO hose reels are tested to provide the best airflow possible, given the size of hose reel and fitted hose. They have a maximum working pressure of 20 bar and operate at temperatures between -30°C and +60°C. Hose reels contri-

bute to a safe and clean working environment. Wall mounting, ceiling mounting and floor mounting (HR open series) make optimizing airflow convenient and easy.



HOSE REELS

The PRO hose reels are tested to give the best airflow compared to size of hose reel and fitted hose. They have a maximum working pressure of 20 bar and a working temperature between -30°C and +60°C. They provide a safe and clean working area and can be mounted on walls and ceilings. The HR open series can also be mounted on the floor.

HR Compact M

Casing	Plastic
Hose inner diam	8 mm
Hose outer diam	12 mm
Working length	10 m
Lead hose	1 m
Inlet connection	1/4" BSP
Outlet connection	1/4" BSP
Hose	Polyurethane
Media	Air
Max pressure	16 bar
Working temp	-30°C to +60°C
Weight	4.5 kg
Ordering No.	8202 1185 00



HR Compact L

Casing	Plastic
Hose inner diam	9.5 mm
Hose outer diam	13 mm
Working length	15 m
Lead hose	1 m
Inlet connection	1/4" BSP
Outlet connection	1/4" BSP
Hose	Polyurethane
Media	Air
Max pressure	16 bar
Working temp	-30°C to +60°C
Weight	6.9 kg
Ordering No.	8202 1185 01

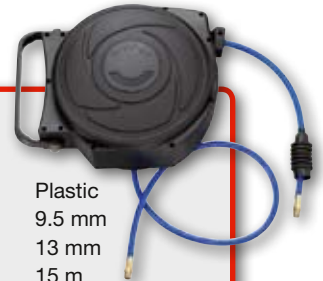

HR Open M

Material	Steel
Hose inner diam	10 mm
Hose outer diam	17 mm
Working length	15 m
Lead hose	1.5 m
Inlet connection	3/8" BSP
Outlet connection	3/8" BSP
Hose	Rubber
Media	Air/water
Max pressure	20 bar
Working temp	-30°C to +70°C
Weight	14 kg
Ordering No.	8202 1185 03



HR Open XL

Material	Steel
Hose inner diam	13 mm
Hose outer diam	20 mm
Working length	15 m
Lead hose	1.5 m
Inlet connection	3/8" BSP
Outlet connection	3/8" BSP
Hose	Rubber
Media	Air/water
Max pressure	20 bar
Working temp	-30°C to +70°C
Weight	16 kg
Ordering No.	8202 1185 04



HR M

Casing	Steel
Hose inner diam	8 mm
Hose outer diam	14 mm
Working length	10 m
Lead hose	1.5 m
Inlet connection	1/4" BSP
Outlet connection	1/4" BSP
Hose	Polyurethane
Media	Air
Max pressure	20 bar
Working temp	-30°C to +60°C
Weight	6.9 kg
Ordering No.	8202 1185 02



Vibration and Noise Emission Values

Measuring vibrations in three directions

A vibration total value is based on a vibration measurement in three directions. The value is the vector sum of the three different directions. The vector sum is always higher than one single direction. On machines intended to be used with two hands, two positions are measured and the position with the highest value is declared. There is no fixed relation between 3-axes and 1-axis values. Therefore comparisons can only be made between values referring to the same part of the same standard. Values with no reference to a standard are meaningless and can not be used for comparisons.

Suitable for comparison purposes only

The declared values given in this table were obtained by laboratory type testing in accordance with the stated standards and are suitable for comparison with the declared values of other tools tested in accordance with the same standards. These declared values are not adequate for use in risk assessments and values measured in individual work places may be higher. The actual exposure values and risk of harm experienced by an individual user are unique and depend upon the way the user works, the workpiece and the workstation design, as well as upon the exposure time and the physical condition of the user.

Measurement of the vibration total value (3-axes value) with new transducer positions according to ISO 28927. Valid from 2010.

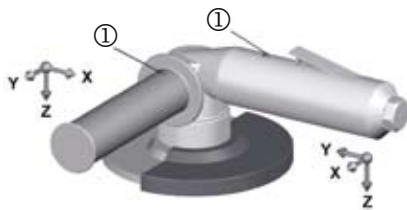

① transducer position

Measurement of the vibration value (1-axis value) with previous transducer positions according to ISO 8662. Valid until 2009.

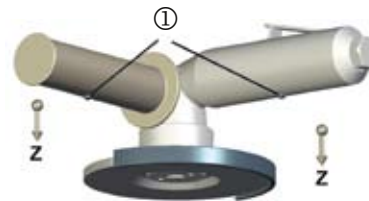

① transducer position

According to the new standard ISO 28927 vibrations are measured in 3 directions both on the trigger and the support handle. The transducer positions are also moved. The new locations between thumb and index finger are chosen to avoid disturbance of the operators normal hand grip.

Power tools may cause hand-arm vibration syndrome if their use is not adequately managed. An EU guide to managing hand-arm vibration can be found at <http://www.humanvibration.com/EU/VIBGUIDE.htm> We recommend a program of health surveillance to detect early symptoms which may relate to noise or vibration exposure, so that management procedures can be modified to help prevent future impairment. All values are current as of the date of this publication.

We cannot be held liable for the consequences of using the declared values, instead of values reflecting the actual exposure, in an individual risk assessment in a workplace situation over which we have no control.



Vibration and Noise Emission Values

Model	Vibration total value (3 axes value) according to ISO 28927-2 Valid from 2010		Vibration value (1 axis value) according to ISO 8662-7 Valid until 2009	Sound pressure levels and sound power levels ^a according to ISO 15744	
	Value 3-axes m/s ²	Uncer- tainty m/s ²	Value 1-axis m/s ²	Sound pressure dB(A)	Sound power dB(A)
	Impact Wrenches				
W2810	6.2	2.3	-	95	106
W2811	6.2	2.3	-	95	106
W2815	7.9	1.3	-	94	105
W2815 Pin retainer	7.9	1.3	-	94	105
W2820	7.9	1.7	-	95	106
W2309	-	-	5	94	105
W2310	-	-	5	94	105
W2311	-	-	5	94	105
W2315	-	-	6.75	94	105
W2320	-	-	4.2	94	105
W2315XP-ATEX	7.3	1.8	6.75	91	116
W2320XP-ATEX	9.6	2.3	4.2	97	116
W2110	7	2.8	<2.5	88	99
W2111	7	2.8	<2.5	88	99
W2210A	4.5	1.1	2.5	99	110
W2211	4.5	1.1	2.5	99	110
W2216	6.1	2.1	6.06	93	104
W2215XTC	6.6	1.2	5.7	97	108
W2219	5.4	1.8	3.3	92	103
W2220	9.2	4.2	9.0	94	105
W2225C	7.8	2.1	3.6	102	113
W2226C	13	2.7	9.0	95	106
W2227	13.5	3.7	8.5	100	111
W2227LA	13.7	3	8.5	105	116
Ratchet Wrenches					
W2630	10.5	6.8	-	86	97
W2631	10.5	6.8	-	86	97
W2620	15	5.1	-	87	98
W2621	15	5.1	-	87	98
W2610	8.8	6.8	-	85	96
W2611	8.8	6.8	-	85	96
W2300	-	-	<2.5	85	96
W2301	-	-	<2.5	85	96
W2302	-	-	<2.5	85	96
W2303	-	-	<2.5	85	96
W2200A	-	-	10	88	99
W2201A	-	-	10	88	99
Battery tools					
B2708	6.6	1.6	6.5	89	100
B2710	6.6	1.6	6.5	89	100
B2715	9.7	3.2	6	92	103

Model	Vibration total value (3 axes value) according to ISO 28927-2 Valid from 2010		Vibration value (1 axis value) according to ISO 8662-1 Valid until 2009	Sound pressure levels and sound power levels ^a according to ISO 15744	
	Value 3-axes m/s ²	Uncer- tainty m/s ²	Value 1-axis m/s ²	Sound pressure dB(A)	Sound power dB(A)
	Screwdrivers				
S2305	<2.5	-	<2.5	83	107
S2326	<2.5	-	<2.5	83	107
S2308-C	<2.5	-	3.7	82	107
S2309-C	<2.5	-	3.7	85	107
S2340-C	<2.5	-	12.0	83	107
S2370-C	<2.5	-	12.0	83	107
S2450-P	<2.5	-	<2.5	78	107
S2451-P	<2.5	-	<2.5	78	107
S2452-P	<2.5	-	<2.5	78	107
S2416-L	<2.5	-	<2.5	73	-
S2426-L	<2.5	-	<2.5	73	-
Screwdrivers					
S2480	6.4	1.2	<2.5	90	101
S2481	6.4	0.9	<2.5	89	100
Drills					
D2112	<2.5	-	<2.5	80	91
D2116	<2.5	-	<2.5	82	93
D2121	2.5	1.2	<2.5	87	98
D2148-R	3.7	1.2	<2.5	85	96
D2160	<2.5	-	<2.5	80	91
D2163	<2.5	-	<2.5	78	89
D2112Q	<2.5	-	<2.5	80	91
D2116Q	<2.5	-	<2.5	82	93
D2121Q	2.5	1.2	<2.5	87	98
D2148-RQ	3.7	1.2	<2.5	85	96
D2160-Q	<2.5	-	<2.5	80	91
D2163-Q	<2.5	-	<2.5	78	89

^a The uncertainty in the sound levels is 3 dB(A).

Additional information about the tests, vibration control and regarding in-use vibrations can be found at the link, www.pro-powertools.com.



Vibration and Noise Emission Values

Model	Vibration total value (3 axes value) according to ISO 28927-1 Valid from 2010		Vibration value (1 axis value) according to ISO 8662-4 Valid until 2009	Sound pressure levels and sound power levels ^a according to ISO 15744		Model	Vibration total value (3 axes value) according to ISO 28927-9 Valid from 2010		Vibration value (1 axis value) according to ISO 8662-2 Valid until 2009	Sound pressure levels and sound power levels ^a according to ISO 15744	
	Value 3-axes m/s ²	Uncertainty m/s ²	Value 1-axis m/s ²	Sound pressure dB(A)	Sound power dB(A)		Value 3-axes m/s ²	Uncertainty m/s ²	Value 1-axis m/s ²	Sound pressure dB(A)	Sound power dB(A)
	Grinders						Percussive				
Vertical grinder											
G2415	5.9	1.9	4.8	84	95	P2520	17	3.2	11.7	78	-
G2416	<2.5	-	4.0	80	91	P2521	-	-	25.4	86	97
Angle grinder											
G 2515	6	2	-	83	94	P2522	-	-	31.6	83	94
G2510-100	6.9	2.3	7	81	92	P2515A	17	4.6	<2.5	88	97
G2510-115	7.9	2.6	7	78	89	P2516A	17	4.2	10.0	95	97
G2510-125	7.6	2.5	7	82	93	P2505	5.6	1	<2.5	72	-
G2510-US	7.6	2.5	7	82	93	P2530-H	12.5	4.8	16.1	96	107
G2510-US-4"	6.9	2.3	7	81	92	P2530-R	12.5	4.8	16.1	96	107
G2510-US-4.5"	7.9	2.6	7	78	89	P2531-H	11.5	4.7	16.1	100	107
G2408-100	6.4	2.1	8.1	81	92	P2531-R	11.5	4.7	16.1	100	107
G2408-115	8.1	2.7	10.0	81	92	P2535-H	-	-	4.7	103	114
G2408-125	10	3.3	11	81	92	P2535-R	-	-	4.7	103	114
						P2536-H	-	-	10.5	103	114
						P2536-R	-	-	10.5	103	114
						P2539-H	-	-	19	102	113
Model	Vibration total value (3 axes value) according to ISO 28927-12 Valid from 2010		Vibration value (1 axis value) according to ISO 8662-13 Valid until 2009	Sound pressure levels and sound power levels ^a according to ISO 15744		Model	Vibration total value (3 axes value) according to ISO 28927-3 Valid from 2010		Vibration value (1 axis value) according to ISO 8662-8 Valid until 2009	Sound pressure levels and sound power levels ^a according to ISO 15744	
	Value 3-axes m/s ²	Uncertainty m/s ²	Value 1-axis m/s ²	Sound pressure dB(A)	Sound power dB(A)		Value 3-axes m/s ²	Uncertainty m/s ²	Value 1-axis m/s ²	Sound pressure dB(A)	Sound power dB(A)
	Grinders						Sanding and polishing				
Die grinder											
G2412-1	<2.5	-	3.6	79	90	G2510 S066	<2.5	-	<2.5	80	91
G2412-2	<2.5	-	3.6	79	90	G2510 S085	<2.5	-	2.6	80	91
G2440	<2.5	-	<2.5	80	91	G2510-S066-M14	<2.5	-	<2.5	80	91
G2445	4.3	1	<2.5	90	101	G2510-S085-M14	<2.5	-	2.6	80	91
G2414-S080	<2.5	-	<2.5	70	-	G2302	<2.5	<2.5	<2.5	81	92
G2414-S120	<2.5	-	<2.5	74	-	G2502	<2.5	-	<2.5	84	95
G2414-S150	2.5	0.7	<2.5	76	-	G2403	<2.5	-	<2.5	87	98
G2414-S200	<2.5	-	3.1	81	92	G2404	<2.5	-	<2.5	87	98
G2414-S250	<2.5	-	<2.5	85	96	G2406	<2.5	-	<2.5	79	-
G2414 S088-US	<2.5	-	<2.5	71	-	G2407	<2.5	-	<2.5	79	-
G2414 S125-US	<2.5	-	<2.5	74	-	G2407M14	<2.5	-	<2.5	79	-
G2414 S155-US	2.5	0.7	<2.5	77	-	G2438-6.3N	3.7	1.7	<2.5	84	95
G2414 S205-US	<2.5	-	3.1	81	92	G2438-6.5N	10.5	4.5	<2.5	85	96
G2414 S255-US	<2.5	-	<2.5	87	98	G2438-6.10N	6.9	3.1	<2.5	87	98
G2422-1	3.4	0.8	5.9	77	-	G2438-6.3I	3.7	1.7	<2.5	84	95
G2422-2	3.4	0.8	5.9	77	-	G2438-6.5I	10.5	4.5	<2.5	85	96
G2424-S080	5.3	1.2	10	<70	-	G2438-6.10I	6.9	3.1	<2.5	87	98
G2424-S120	<2.5	-	10.3	73	-	G2438-6.3C	3.7	1.7	<2.5	84	95
G2424-S150	<2.5	-	5.6	76	-	G2438-6.5C	10.5	4.5	<2.5	85	96
G2424-S200	<2.5	-	2.6	81	92	G2438-6.10C	6.9	3.1	<2.5	87	98
G2424-S250	3.5	0.8	2.5	85	96	G2301	13	1.8	5.6	84	95
G2424 S088-US	5.3	1.2	10	<70	-	G2428	6.8	3.2	<2.5	87	98
G2424 S125-US	<2.5	-	10.3	73	-						
G2424 S155-US	<2.5	-	5.6	76	-						
G2424 S205-US	<2.5	-	2.6	81	92						
G2424 S255-US	3.5	0.8	2.5	85	96						
G2451	2.9	1.4	<2.5	79	-						

^a The uncertainty in the sound levels is 3 dB(A).

Additional information about the tests, vibration control and regarding in-use vibrations can be found at the link, www.pro-powertools.com.



PRO SPARE PARTS GUIDE

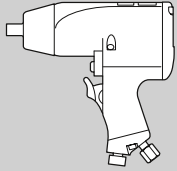

IMPACT WRENCHES

Tool	Spare part	Ordering No.
W2210	Hex kit	4112 1544 90
W2210/W2111	Silencer kit	4112 1540 90
	Valve kit	4112 1541 90
	Trigger kit	4112 1542 90
	Motor kit	4112 1543 90
	Service kit	4081 0211 90
	Seal kit	4081 0212 90
	Motor unit kit	4081 0227 90
W2215 XTC	Small parts kit	4081 0301 90
	Seal kit	4081 0302 90
	Service kit	4081 0303 90
W2216	Valve kit	4112 3001 90
	Motor unit kit	4112 3001 92
	Trigger kit	4112 3001 93
	Exhaust kit	4112 3001 94
	Impact mechanism kit	4112 3001 95
W2219	Seal kit	4081 0048 90
	Service kit	4081 0157 90
	Motor unit kit	4081 0158 90
W2220/W2226	Small parts kit	4081 0383 90
	Seal kit	4081 0384 90
	Inlet kit	4081 0385 90
	Motor unit kit	4081 0386 90
	Service kit	4081 0388 90
W2225C	Seal kit	4081 0049 90
	Motor unit kit	4081 0050 90
	Service kit	4081 0159 90
W2227	Motor unit kit	4112 1538 90
	Small parts kit	4112 1537 90
W2309/W2310/W2311	Small part kit	4081 0342 90
	Gasket kit	4081 0343 90
	Inlet kit	4081 0344 90
	Motor unit kit	4081 0345 90
	Reverse switch kit	4081 0346 90
	Hammer cage kit	4081 0347 90
W2311/W2315	Socket retainer kit	4081 2036 90
W2315	Hammer cage kit	4081 2035 90
	Reverse switch kit	4081 2037 90
W2315-ATEX	Reverse switch kit	4081 0392 90
	Hammer cage kit	4081 0395 90
W2315/W2315-ATEX	Small parts kit	4081 2029 90
	Seal kit	4081 2030 90
	Inlet kit	4081 2031 90
	Motor unit kit	4081 2032 90
	Gasket kit	4081 2033 90
	Function kit	4081 2036 90
W2320	Hammer cage kit	4081 0362 90
	Reverse switch kit	4081 0363 90
W2320-ATEX	Reverse switch kit	4081 0393 90
	Hammer cage kit	4081 0396 90
W2320/W2320-ATEX	Small parts kit	4081 0356 90
	Seal kit	4081 0357 90
	Inlet kit	4081 0358 90
	Motor unit kit	4081 0359 90
	Gasket kit	4081 0360 90

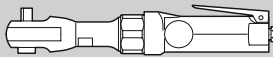

RATCHET WRENCHES

W2200A/W2201A	Small parts kit	4081 0051 90
	Vane and ball bearing kit	4081 0160 90

SCREWDRIVERS

S2305/S2326	Motor unit kit	4081 0054 90
S2305/S2326/S2308-C	Service kit	4081 0053 90
S2308-C	Small parts kit	4081 0055 90
S2308-C/S2309-C	Motor unit kit	4081 0163 90
S2340-C/S2370-C	Service kit	4081 0078 90
S2416-L/S2426-L	Service kit	4081 0073 90
S2450-P	Service kit	4081 0076 90
S2451-P/S2452-P	Service kit	4081 0077 90
S2480	Impact mechanism	4112 1522 90
	Motor kit	4112 1523 90
	Valve kit	4112 1525 90
	Exhaust kit	4112 1526 90
S2480/S2481	Quick change chuck	4112 1521 90
	Trigger kit	4112 1524 90
S2481	Impact mechanism	4112 1527 90
	Motor kit	4112 1528 90
	Valve kit	4112 1529 90
	Exhaust kit	4112 1530 90

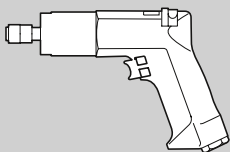



PRO SPARE PARTS GUIDE

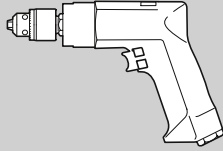

DRILLS

Tool	Spare part	Ordering No.
D2112//D2116/D2121	Service kit	4081 0056 90
	Motor unit kit	4081 0057 90
	Bearing kit	4081 0058 90
D2148-R	Service kit	4081 0053 90
	Motor unit kit	4081 0054 90
	Bearing kit	4081 0161 90
D2163	Bearing kit	4081 0062 90
	Service kit	4081 0080 90

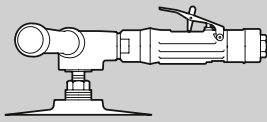

GRINDERS

G2301/G2302	Motor unit kit	4112 1503 90	
	Cylinder kit	4112 1504 90	
G2403	Small part kit	4081 0228 90	
	Motor unit kit	4081 0230 90	
	Apron	4081 0231 90	
G2403/G2404	Seal kit	4081 0229 90	
	G2404	Small part kit	4081 0232 90
G2406/G2407	Motor unit kit	4081 0233 90	
	Apron	4081 0234 90	
	Bearing kit	4081 0062 90	
G2408	Motor unit kit	4081 0057 90	
	Small part kit	4081 0080 90	
	Motor unit kit	4081 0080 90	
G2412/G2422	Bearing kit	4081 0061 90	
	Service kit	4081 0063 90	
	Motor unit kit	4081 0080 90	
G2414/G2424	Motor unit kit	4081 0165 90	
	Small part kit	4081 0265 90	
	Seal kit	4081 0266 90	
G2415/G2416	Motor unit kit	4081 0267 90	
	Motor unit kit	4081 0081 90	
	Service kit	4081 0067 90	
G2428	Small parts kit	4081 0066 90	
	Service kit	4081 0169 90	
	Motor unit kit	4081 0170 90	
G2438	Small parts kit	4081 0205 90	
	Motor unit kit	4081 2026 90	
	Service kit	4081 2027 90	
G2451	Small part kit	4081 0348 90	
	Motor unit kit	4081 0349 90	
	Service kit	4081 0350 90	
	Cylinder kit	4081 0351 90	
	Service kit	4081 0352 90	
	Service kit	4081 0364 90	
	Service kit	4081 0365 90	
	G2502	Motor unit kit	4112 1518 90
	G2510	Valve seat kit	4150 1657 90
	Exhaust kit	4150 1648 90	
	Motor unit kit	4081 0432 90	



ENGRAVING PEN

P2505	Needle and small parts kit	4081 0068 90
-------	----------------------------	--------------

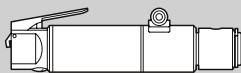

CHIPPING HAMMERS

P2515A/P2516A	Small parts kit	4081 0052 90
P2525/P2526	Service kit	4081 0059 90
P2531	Valve kit	4112 1517 90
P2535	Valve kit	4112 1508 90
P2536/P2539	Front kit	4112 1511 90
	Valve kit	4112 1510 90

DIMENSIONAL DRAWINGS

Impact wrenches

Model / (mm) Fig. 1	a	b	c	d
W2310	60	175	160	56
W2311	60	175	160	56
W2315	70	180	190	64
W2320	90	220	235	64
W2315 XP	70	180	190	64
W2320 XP	90	220	235	64
W2110 HEX	-	-	160	-
W2111 3/8"	-	-	154	-
W2210A 3/8"	78	180	160	57
W2211 1/2"	78	180	160	57
W2214 XT 1/2" Comp	95	200	200	60
W2215 XTC 1/2"	90	190	190	65
W2219 3/4"	-	235	255	82
Model / (mm) Fig. 2	a	b	c	d
W2220 3/4"	270	244	92	66
W2225C 1"	290	270	133	66
W2226C 1"	270	244	92	66

Drills

Model / (mm) Fig. 1	a	b	c	d
D2163	242	50	110	128
Model / (mm) Fig. 2	a	b	c	d
D2121	248	152	40	170
D2148-R reversible	248	152	40	170
D2121Q	248	152	40	170
D2148-RQ	248	152	40	170
Model / (mm) Fig. 3	a	b	c	
D2112	206	135	40	
D2116	211	135	40	
D2112Q	206	135	40	
D2116Q	211	135	40	

Ratchet wrenches

Model / (mm) Fig. 1	a	b	c
W2300 3/8"	58	258	108
W2301 1/2"	58	258	108
W2303 3/8"	48	195	65
W2302 1/4"	48	195	65
W2200A 3/8"	58	258	108
W2201A 1/2"	58	258	108

Screwdrivers

Model / (mm) Fig. 1	a	b	c	d
S2480	132	108	40	166
S2481	143	119	42	166
S2305	198	85	40	135
S2326	178	85	40	135
S2308-C	225	85	40	135
S2450-P	225	85	40	135
Model / (mm) Fig. 2	a	b	c	
S2340-C	62	250	38	
S2370-C	62	250	38	
S2416-L	62	230	38	
S2426-L	61	230	38	

Angle grinders & vertical grinders

Model / (mm) Fig. 1	a	b	c	d	e
G2408-100	114	225	40	30	128
G2408-115	126	225	40	30	128
G2408-125	138	225	40	30	128
G2409-100	114	260	50	30	144
G2409-115	126	260	50	30	144
G2409-125	138	260	50	30	144
G2409-100-M14	114	260	50	30	144
G2409-115-M14	126	260	50	30	144
G2409-125-M14	138	260	50	30	144
G2510-115	126	207	47	30	126
G2510-125	134	207	47	30	126
Model / (mm) Fig. 2	a	b	c	d	
G2415	198	280	190	268	
G2416	198	280	190	268	

DIMENSIONAL DRAWINGS

Die grinders

Fig. 1

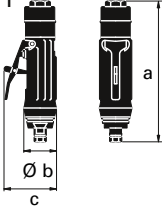

Model / (mm) Fig. 1	a	b	c
G2412-1	178	44	71
G2412-2	178	44	71
G2414 S080	215	48	71
G2414 S150	215	48	71
G2414 S200	215	48	71
G2414 S250	215	48	71

Fig. 2

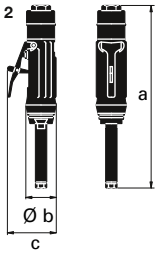

Model / (mm) Fig. 2	a	b	c
G2422-1	277	44	71
G2422-2	277	44	71
G2424-S080	315	48	71
G2424-S120	315	48	71
G2424-S150	315	48	71
G2424-S200	315	48	71
G2424-S250	315	48	71

Sanders

Fig. 1

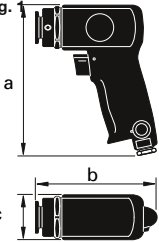

Model / (mm) Fig. 1	a	b	c
G2302	130	109	35
G2402	155	124	45
G2502	172	108	50

Model / (mm) Fig. 2	a	b	c	d
G2403	80	140	280	70
G2404	100	145	360	90

Fig. 2

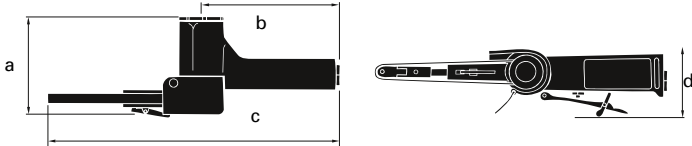

Polishing sanders

Model / (mm) Fig. 1	a	b	c	d	e	f
G2406	135	120	50	150	300	215
G2407	135	120	50	150	300	215

Fig. 1

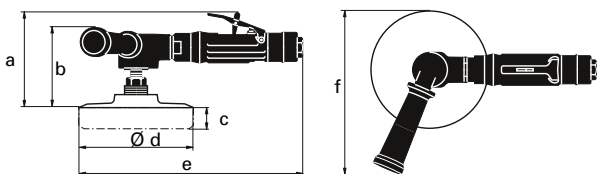

Random orbital sanders

Fig. 1

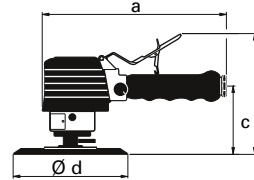

Model / (mm) Fig. 1	a	b	c	b	e	f
G2401	180	155	85	150	42	73

Model / (mm) Fig. 2	a	b	c
G2301	130	117	35

Fig. 2

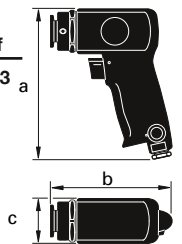
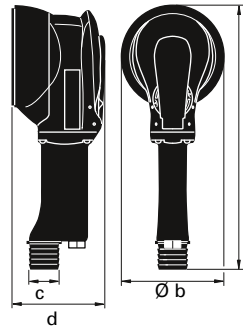
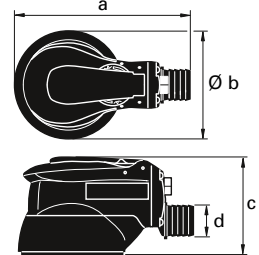

Fig. 3



Model / (mm) Fig. 3	a	b	c	d
G2428	282	100	29	100

Fig. 4



Model / (mm) Fig. 4	a	b	c	d
G2418	170	100	100	29
G2438-N	170	150	105	29
G2438-L	235	150	105	29
G2438-C	230	150	105	29

Percussive tools

Fig. 1

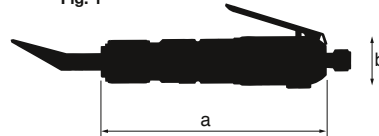

Model / (mm) Fig. 1	a	b
P2520	182	36
P2521	204	44

Fig. 2

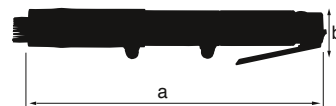

Model / (mm) Fig. 2	a	b
P2515	228	58
P2516	373	58



DIMENSIONAL DRAWINGS

Model / (mm) Fig. 3	a	b
P2525	218	154
P2526	218	154
P2530-H	140	146
P2530-R	140	146
P2531-H	206	146
P2531-R	206	146

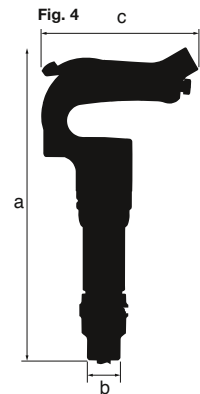
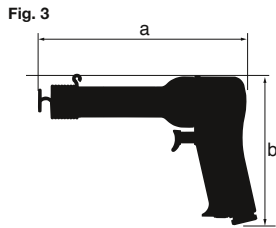

Model / (mm) Fig. 4	a	b	c
P2535-H	281	23	142
P2535-R	281	23	142
P2536-H	343.5	46	158
P2536-R	343.5	46	158
P2539-H	467.5	46	158

Model / (mm) Fig. 5	a	b
P2505	175	19

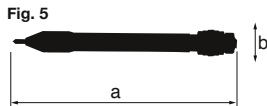

CONVERSION TABLE

LENGTH	PRESSURE
1 in = 0.0254 m	1 bar = 100 kPa
1 m = 39.3701 in	1 kp/cm ² (at) = 98.0665 kPa
3.2808 ft	1 psi = 6.8948 kPa
1 mm = 0.0393701 in	1 kPa = 0.0101972 kp/cm ² (at)
WEIGHT	POWER
1 lb = 0.4536 kg	1 kpm/s = 9.8067 W
1 kg = 2.2046 lb	1 hp = 745.7 W
TORQUE	101.972 kpm/s
1 kpm = 9.8067 Nm	1 kW = 1.3410 hp
1 Ft lb = 1.3558 Nm	FLOW
TORQUE	1 m ³ /min = 16.6667 l/s
1 In lb = 0.1130 Nm	1 cfm = 0.4720 l/s
1 Nm = 0.1020 kpm	1 m ³ /h = 0.2778 l/s
0.7376 ft lb	1 l/s = 2.1189 cfm



CHOICE OF A CHAMPION

www.pro-powertools.com



PRO industrial tools deliver unequalled quality, performance and durability.
PRO is widely recognized around the world as the natural choice for professional-grade tools.